

smarter

faster

easier



woodWOP⁹

Update now!

Your advantages at a glance:

- **The new design makes orientation easy** thanks to the significantly larger graphics area with clean lines.
- **The individually configurable favorites mode** reduces the parameter menu to the essentials. More space for the workpiece and programming options.
- **Reduced programming time through process optimization** using new functions and assistants.



More at
www.homag.com

woodWOP 9.0 – Update now!

We offer:

- **Updating** your CNC machining to the new version
- **Coordinated planning and support** for updating your CNC machine(s)
- **New features and assistants** that optimize processes

You receive:

The new design

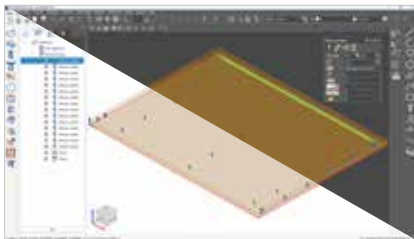

- Larger graphics area
- Light and dark mode
- Clean lines and consistent color scheme

Favorites mode



- Display of the most important parameters in a compact overview
- Customizable via drag & drop
- Switching within the macro family

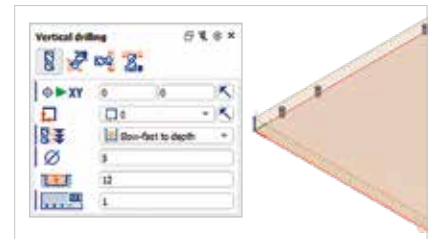

Drag & drop, object snap & multiselect

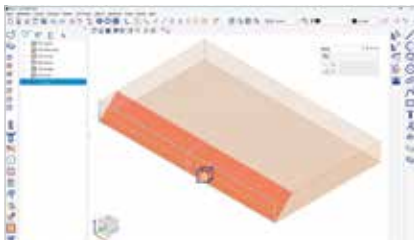

- Drag & drop contours, macros, components and levels

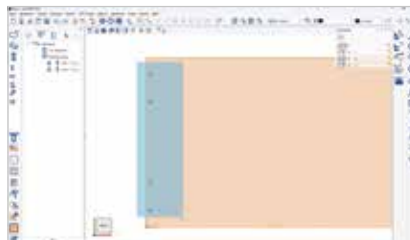

- Multiselect in the graphics area

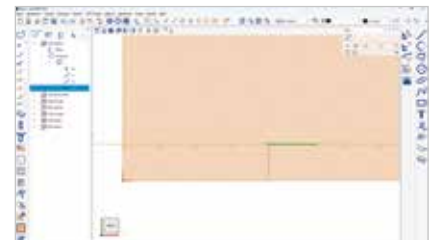

- Intelligent snap points and snap lines



Are you interested?

Nothing could be easier...

Your contact person will be happy to tell you more!

info-deutschland@homag.com
+49 5245 92 200



SCAN IT!

You can find out more about woodWOP[®] here.