

Simply control elements

Modular, flexible, adaptable.
Our BUILDTEQ assembly tables.



HC | WEINMANN

Building living spaces.

From furniture to homes: The future is built with wood.

Together, HOMAG, WEINMANN, SYSTEM TM and KALLESOE provide comprehensive production solutions for manufacturers of optimized timber, engineered wood, timber construction, interior fittings, furniture and more. With over 500 years of combined experience in machinery engineering, automation systems, and software technology, our focus is on building strong partnerships that enhance your productivity, precision, and profitability.

This is how we are Building living spaces. Together, with you.

HOMAG – YOUR SOLUTION

Modular technology for carpenters, module manufacturers and the prefabricated house industry from WEINMANN.

WEINMANN offers everything for timber construction – from machines and production lines to suitable software solutions and consulting as well as life cycle services. We support you right from the start and accompany you through the entire process to find the right solution for your business. Many companies have already found it.

That is our idea of efficiency. This is how we are Building living spaces. Together, with you.

Building living spaces.

Building efficiency.

Timber construction – from A to Z.



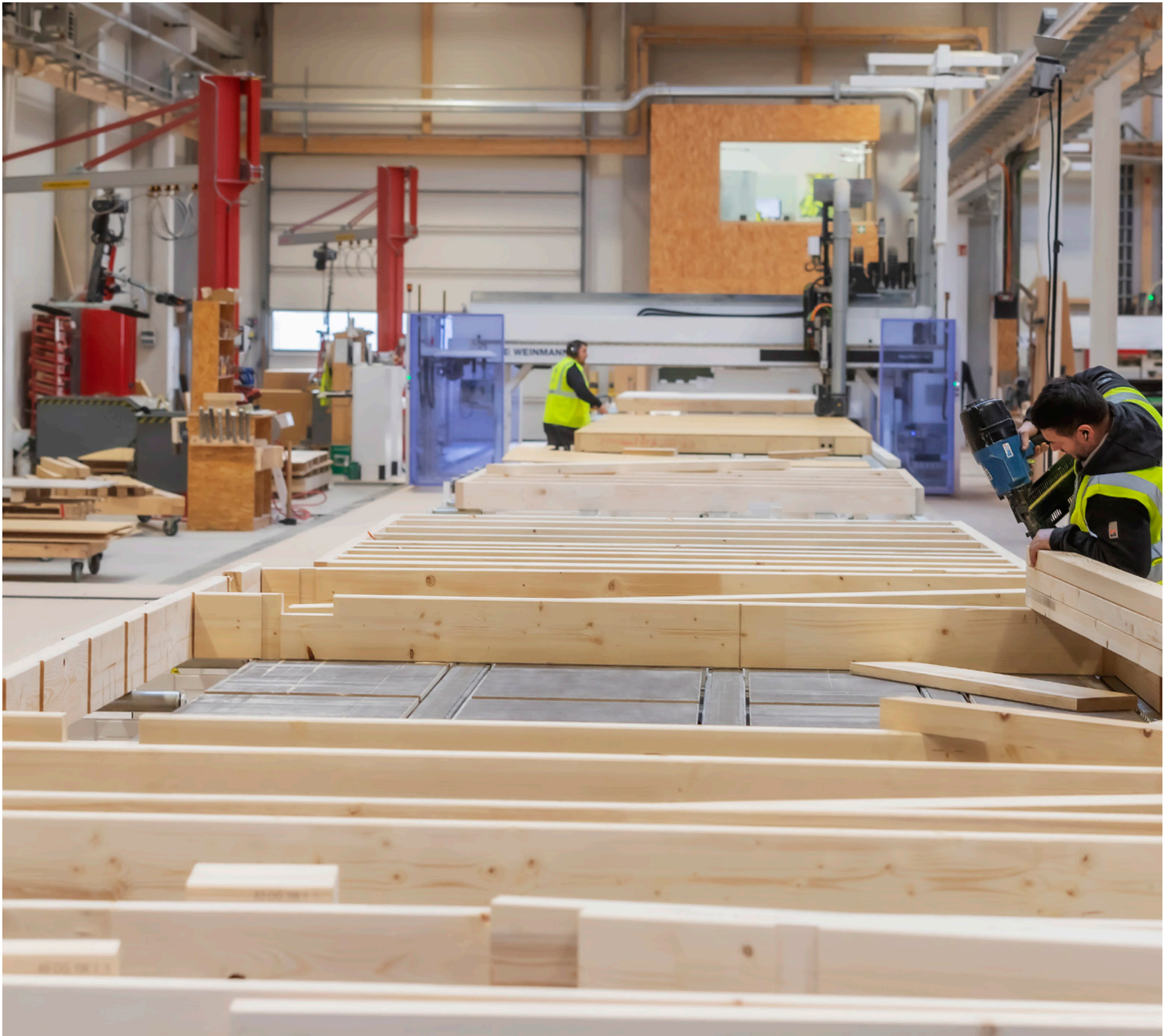

BUILDTEQ assembly tables

Versatile and future-proof

Assembly tables from the BUILDTEQ series enable you to easily manufacture wood frame construction elements with a high degree of dimensional accuracy. With these tables, we offer you solutions that can be integrated to optimum effect both in woodworking shops and in industrial production. They are suitable for a wide range of applications including manufacturing wall, roof, floor and gable elements. The higher level of prefabrication and the consistently high quality increase efficiency in your production operations.

YOUR SOLUTION

CONTENTS

6	Benefits of element production with an assembly table
8	BUILDTEQ assembly tables for woodworking shops
10	BUILDTEQ A-100
12	BUILDTEQ A-300
14	Extension options for BUILDTEQ A-100 and 300
16	Butterfly turning table
20	BUILDTEQ A-500
26	BUILDTEQ A-600
32	Control technology
33	Product range
34	Technical data
36	Life Cycle Services
38	Academy
40	SCHULER consulting package

Benefits of element production with an assembly table

The assembly tables in the BUILDTEQ series are ideal ergonomically and efficiently manufacturing rectangular wood frame construction elements and can be extended on a modular basis.



THE BENEFITS AT A GLANCE:

Many companies still manufacture elements completely by hand and without additional aids. The BUILDTEQ assembly tables offer a variety of functions and extension options that simplify production sequences and processes and relieve the burden on your employees.

SAFE AND ERGONOMIC:

- Ergonomic working height
- All control elements are installed on the table itself
- Safe work operations thanks to solid, non-slip sheathing

UNIVERSAL APPLICATION:

- Can be used to manufacture wall, roof, floor and gable elements
- Supports simultaneous manufacture of two elements on one assembly table thanks to two separate clamping circuits

POTENTIAL FOR MODULAR EXTENSION:

- The BUILDTEQ modular design creates potential to continuously increase capacity, even with the flat-pack table version
- Production processes can be optimized incrementally
- Extension options such as the butterfly turning table or the multifunction bridge are available to optimize production processes

IDEAL ENTRY-LEVEL OPTION FOR WOODWORKING SHOPS:

- Optimum solution for small and medium-sized enterprises
- Supports production of special elements such as gables, bays and knee walls

SUSTAINABLE THINKING:

- The installed profiles can be reutilized in the next expansion stage of the assembly table

BUILDTEQ

assembly tables for woodworking shops

Ideal for your needs

The BUILDTEQ series is available in various designs for use in woodworking shops. Whether it's a flat-pack table, insert table or tilt table — there is a wide range of variants available to you.

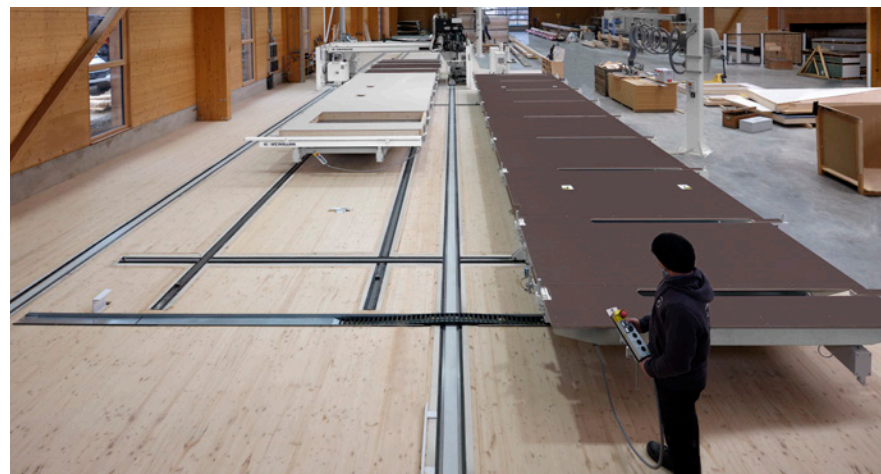

WELL-POSITIONED — EVEN WITH THE STANDARD FEATURES

Even the standard features of the BUILDTEQ assembly tables incorporate useful details that make your everyday work much easier. The sturdy design allows heavy and complex elements to be processed. Elements with a weight of up to 3.5 tons can be manufactured using the standard features.



C-POWERTEC CLAMPING BEAMS

Automated frame work clamping means that elements can be manufactured with more ease and at greater speed.

- Reduced manufacturing times: The plate and stud are clamped without any gaps and can be joined immediately using nails
- Variety of elements: Pneumatic clamping beams with extensions allow production of elements up to 3.8 m wide, for use in commercial construction, for example
- High level of quality: A precise horizontal position is guaranteed, even at full extension



X STOP

Elements can be aligned at the correct angle at the X stop.

- Precise assembly thanks to exact alignment at an angle of 90°
- Elements can be aligned either at stop pins or at a continuous stop profile

TWO CLAMPING CIRCUITS

Simultaneous manufacture of two elements on one work table.

- Separate clamping circuits mean that two elements can be clamped
- Available for all assembly tables from a length of 8 m



BUILDTEQ A-100 flat-pack table

We provide the technology, you provide the wood.

We combine our core expertise with yours to offer you a simple yet high-performance solution for a reduced budget. This allows you to bring the BUILDTEQ to life yourself with the help of our technology, our framing program and your resources.

To make it easy for you to set up the assembly table, WEINMANN provides you with easy-to-understand assembly instructions, the required technology and a video guide so that you can make full use of the BUILDTEQ A-100. All required components, such as the pneumatic unit and clamping profiles, are included in the scope of delivery and clearly marked.

You provide the wood for the substructure. The subsequent setup process can then be performed quickly and easily.

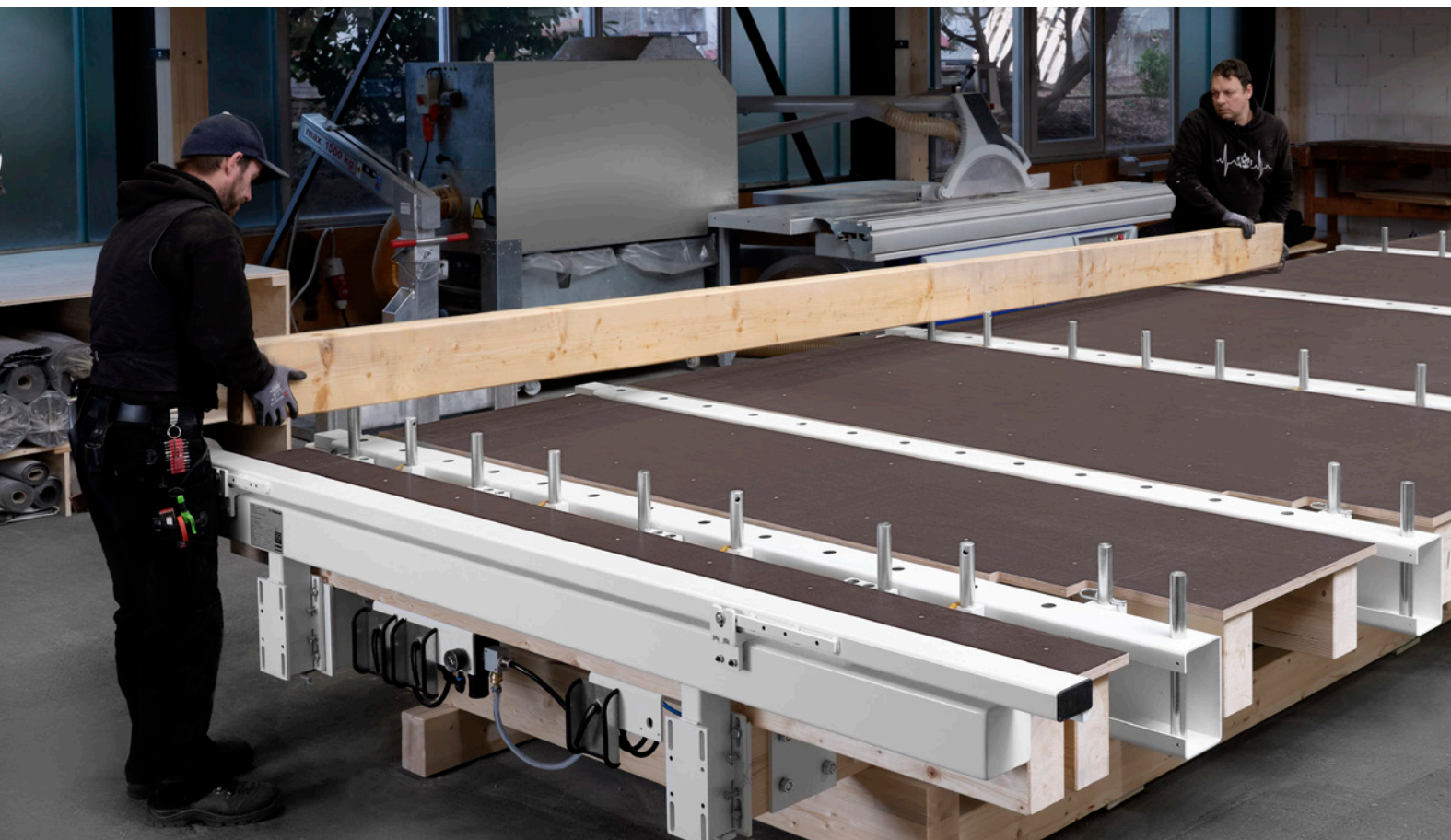

HIGH-QUALITY EQUIPMENT:

- C-PowerTec clamping beams
- Precise angled stop system
- Pneumatics systems for the central air supply and control of the C-PowerTec clamping beams
- Fixtures for connecting to the table base frame
- Detailed assembly instructions
- Optional roof/ceiling clamping units
- Two separate clamping circuits for clamping two elements

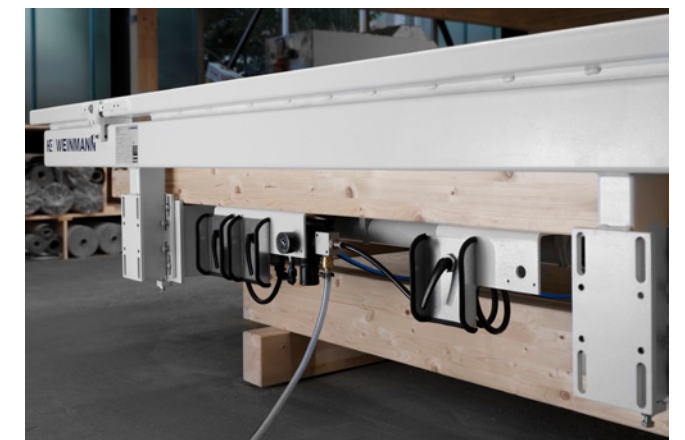

PRACTICAL APPLICATION OPTIONS

- Universal application for wall, roof and floor elements in wood frame construction
- Can be extended with modules to make a carpentry table or combined with a multifunction bridge

BUILDTEQ A-300 carpentry table

Universal application

These carpentry tables are ideally suited to manufacturing wall, gable, roof and floor elements, as well as frame walls and roof dormers. The integrated technology guarantees a high level of dimensional and angular accuracy. Extension to include optional features supports adaptation to your individual requirements. The integration of chassis and hydraulic tilt functions also enables you to turn elements with ease.



FUNCTIONAL DETAILS:

- Clamping system: The automated clamping system enables frame work to be manufactured quickly and easily
- X and Y stops: X and Y stops allow for alignment at the correct angles
- Element ejector: Optional for turning roof/floor elements. An integrated element ejector pushes the element out of the clamping units pneumatically during the turning operation
- Chassis: Chassis in the longitudinal and transverse direction enable adapted element positioning, as well as the combination of several assembly tables in one production system
- (Option) Integrated hydraulics: The carpentry table tilts itself to turn the elements. This allows the element to be removed, rotated and repositioned using the overhead crane



Extension options

BUILDTEQ A-100 and BUILDTEQ A-300

ROOF/CEILING CLAMPS:

The roof rafters and beams are inserted into the opened clamps and fixed in place. When the manual slide valve is closed, the beams are correctly aligned and tensioned. This also corrects slight twists. The stop point is defined separately for each beam, allowing a high degree of dimensional accuracy to be achieved regardless of the dimensions of the individual beam.

- Each beam is clamped individually
- The clamping pairs can be fixed in place anywhere on the beam
- Precise positioning using measuring tapes
- Optional: Individual roof/ceiling clamps or roof/ceiling clamp package (12 units)

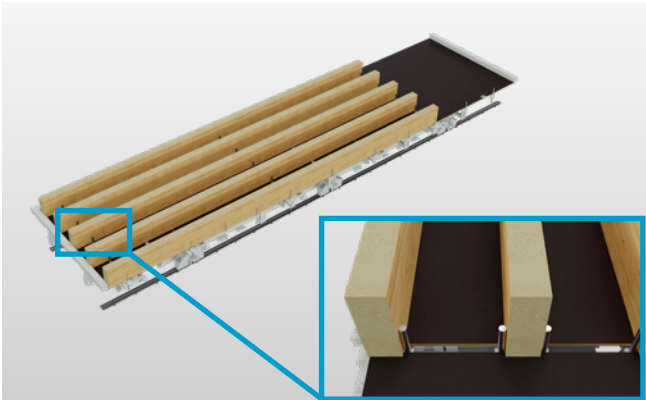

MEASURING TAPE:

Aid for more precise positioning of wood or clamping devices. The measuring tape arranged in the transverse direction is an aid that enables more precise positioning of wood or clamping devices. Available in both metric and imperial versions.



PNEUMATIC AND ELECTRICAL CONNECTION OPTIONS:

Enables the use of handheld units through connections on the longitudinal side of the table.

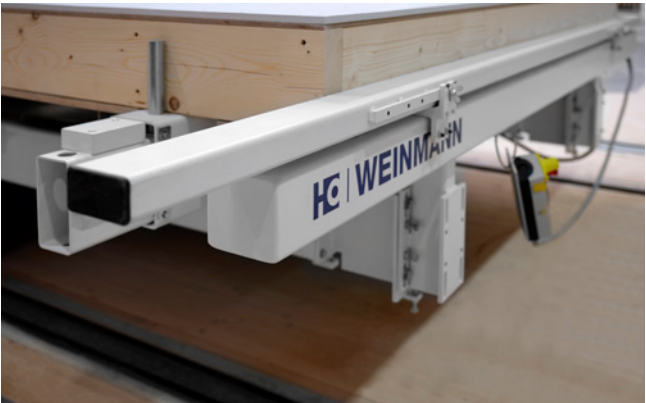

CONTINUOUS X STOP:

Precise alignment of roof and floor elements. The universal stop pipe is 3.2 m long.



UNIVERSAL CLAMPS:

For clamping the top and bottom plates, as well as studs, spandrels and diagonal gable timber. The clamp can be positioned individually on the profiles.



SECOND X STOP:

Enables simultaneous alignment of two elements on one assembly table. Both elements are aligned simultaneously with the second X stop.



DIFFERENT PIN LENGTHS AND HEIGHT-ADJUSTABLE PINS:

Stop pins for correct alignment and safe turning. The pins are suitable for various element thicknesses.

Butterfly turning table

Turning in a single movement

WEINMANN butterfly turning tables offer you the ideal solution for turning elements. Two assembly tables move to positions opposite each other. The element is then transferred from one table to another during tilting. The entire turning operation is performed exclusively with the two assembly tables; no overhead crane is required. The entire operation is completed in just 90 seconds. This process also significantly increases the level of work safety and reduces the risk of damage to the element. The two assembly tables also serve as two separate workstations on which work can be performed in parallel.



PRODUCE CLOSED ELEMENTS — EFFICIENTLY AND EASILY

The frame work is created on the feeder table. The sheathing is then placed on top and secured. The hydraulic system on the tables means that the feeder table can be tilted to transfer the element to the receiving table. The receiving table also has a chassis and moves parallel to the feeder table. The receiving table tilts opposite the feeder table and takes over the element. After the turning operation, plumbing and electrical installations are installed using the receiving table and the insulation is attached. The second side of the element is then closed and secured. This means that with just two people, you can achieve a capacity of up to 30 houses per year.

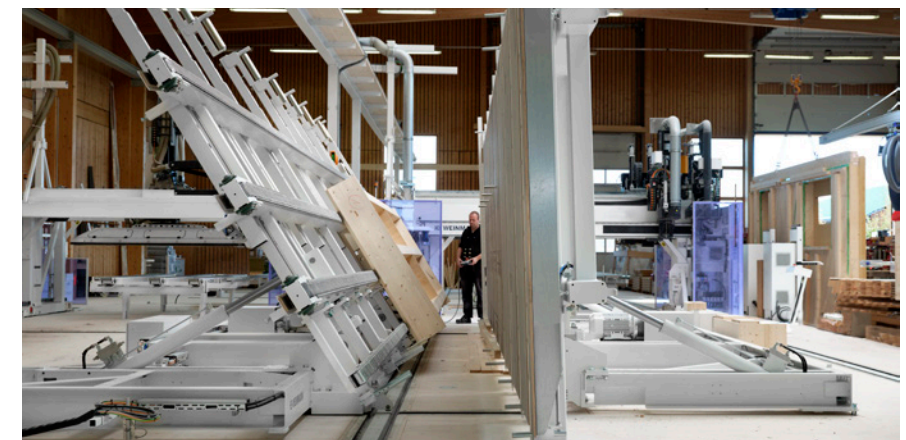

FAST AND SAFE
TURNING OPERATION:

- Faster turning process — within just 90 seconds
- Safe turning operation that protects the workpiece without the use of a crane
- Ergonomic work sequence thanks to short distances and optimum heights
- Simplified handling
- Optimized space

PARALLEL BUTTERFLY TURNING
TABLES — THE ENTRY-LEVEL
SOLUTION

In this system, the receiving table has a chassis in the transverse direction, allowing parallel movement into various positions. The position of the assembly table can thus be adjusted so that employees have enough space to work on both tables. Parallel movement also means that elements of different thicknesses can be turned. The sensors installed specify the corresponding position for the turning operation to the feeder table. The parallel butterfly turning table requires a hall space of just 12 x 7 m to manufacture 12-m elements.

LONGITUDINAL/TRANSVERSE
BUTTERFLY TURNING TABLES —
EXPANDABLE AND ADAPTABLE

On longitudinal/transverse butterfly turning tables, the feeder table also has a chassis in the longitudinal direction. Both assembly tables are positioned in a line and can be moved to the corresponding position as required. The feeder table moves in the longitudinal direction and the receiving table moves in the transverse direction. This system can be combined with a multifunction bridge, and can therefore be expanded later to form a compact system. The defined production sequence optimizes material logistics and increases productivity.



WEINMANN
Butterfly turning table

	PARALLEL BUTTERFLY TURNING TABLE	LONGITUDINAL/TRANSVERSE BUTTERFLY TURNING TABLE
	Entry-level solution	Expandable and adaptable
Hydraulic swivel device	x	x
Full-surface sheathing	x	x
Transverse chassis	x	x
Combination of longitudinal and transverse chassis	-	x
Can be expanded with the addition of a multifunction bridge	-	x
Individually configurable	-	x
Space requirement for 12-m tables	Approx. 100 m²	Approx. 153 m²

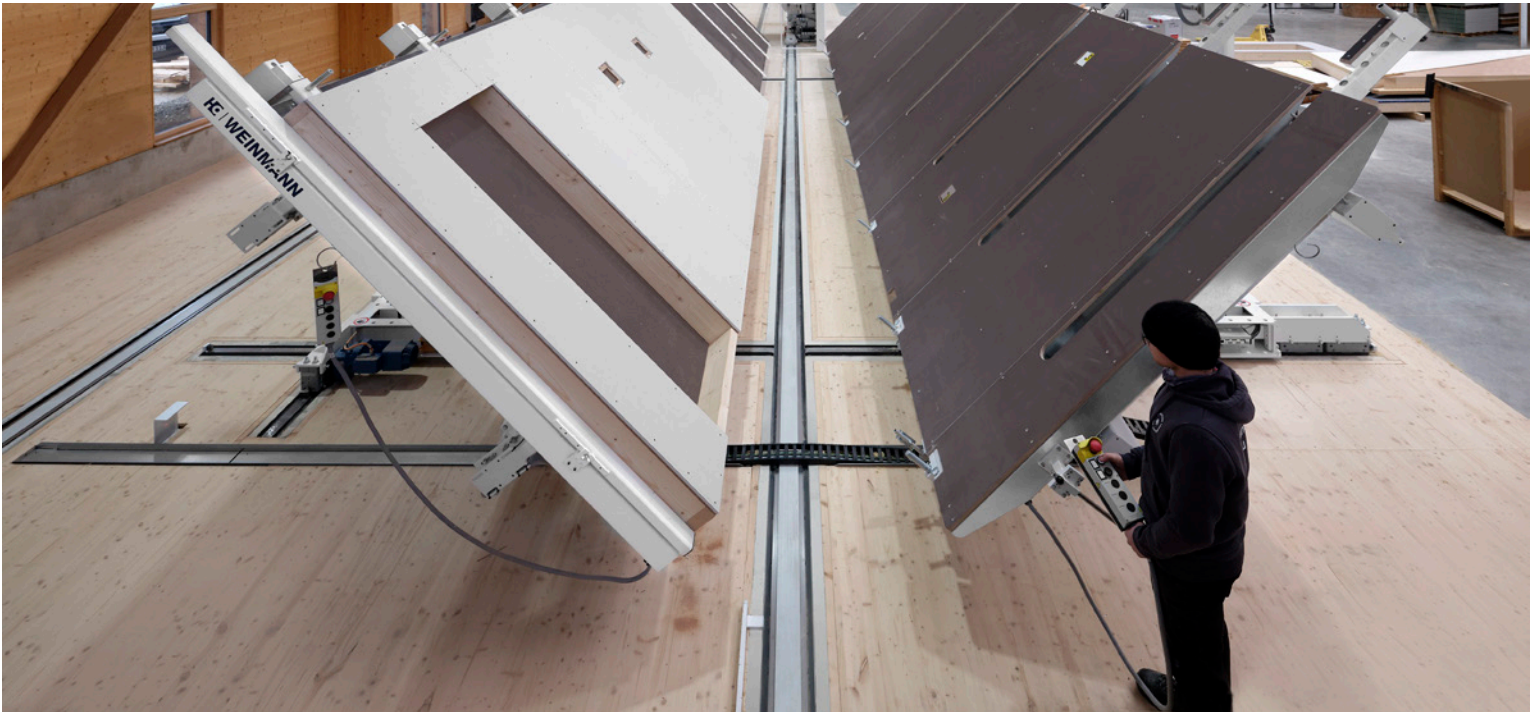

BUILDTEQ A-500 element table

Flexible in industrial production

The BUILDTEQ series element tables are truly versatile components in the production line and take over tasks such as turning elements, aligning elements at the correct angle to ensure safe sheathing and processing, transport and tilting for storage.

You can customize the configuration of the BUILDTEQ A-500 to suit your production situation. The benefit for you: If your capacity output increases, your assembly table grows with you. Thanks to the wide range of extension options, the table can be expanded at any time and adapted to higher levels of automation.



TRANSPORT USING ROLLER STRIPS
Roller strips are used for manual transport of elements in the longitudinal direction.



OPTION: PLASTER PACKAGE
Rubber rollers, specially designed for manufacturing elements with plaster sheathing, are fitted to the infeed side of the table.



AUTOMATIC ELEMENT DETECTION AT THE X STOP
The infeed transport is slowed down, ensuring that the element is not damaged during the operation.



MOTORIZED ELEMENT TRANSPORT
Three hinged slat conveyors and roller conveyors on the bottom plate.

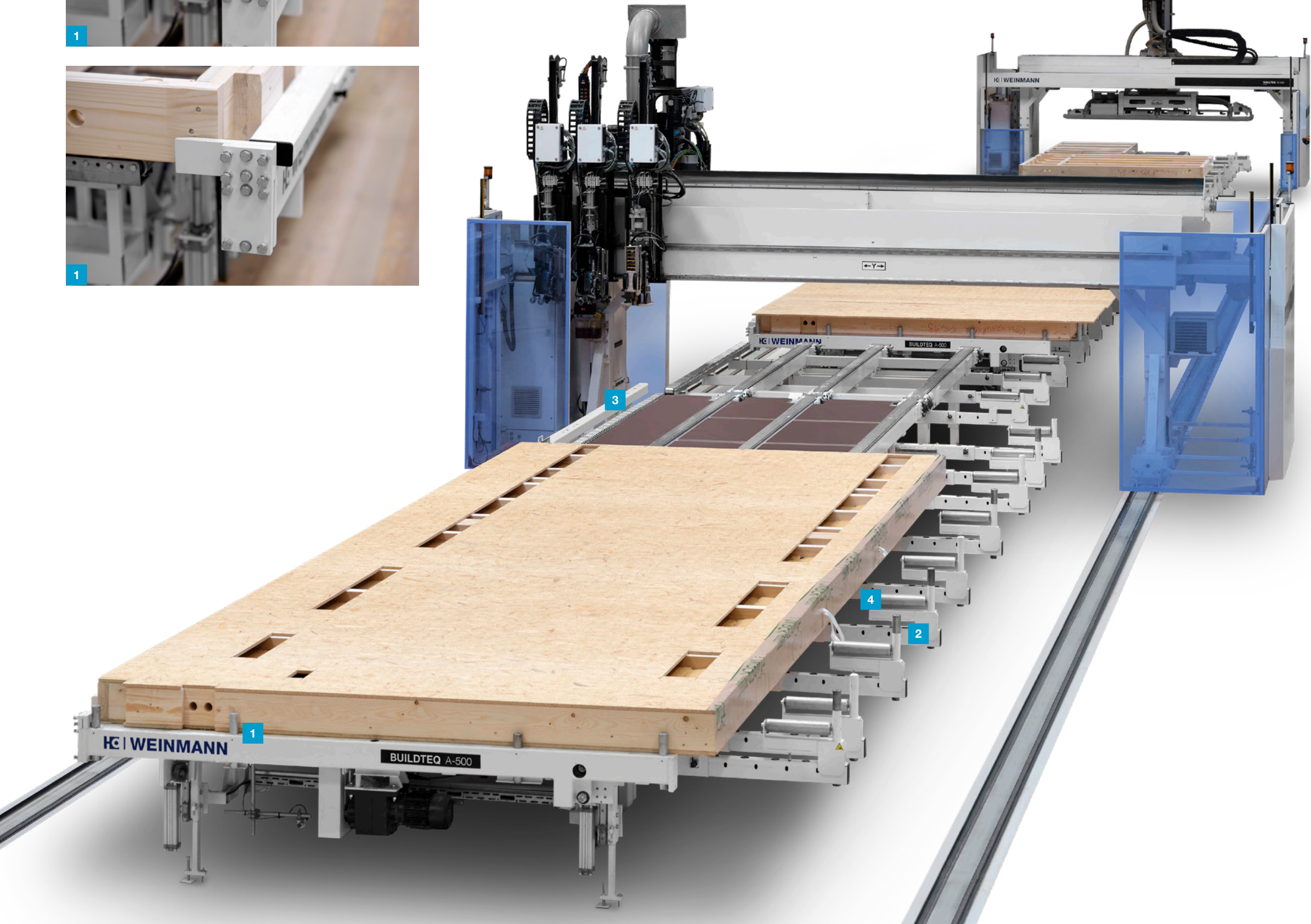

1 X STOP CAN BE LOWERED PNEUMATICALLY

Elements are aligned at the correct angle.

2 OPTION: PNEUMATIC MAIN CLAMP

The element is aligned and fixed in place so that the sheathing can be attached and secured.

3 Y STOP

Elements are aligned at the correct angle.

4 OPTION: MORE STABILITY FOR UP TO 420 KG ELEMENT WEIGHT PER METER

The reinforced element support with steel rollers is available as an option to give the assembly table additional stability and is particularly suitable for heavy elements. As an option, the rollers are also available with a rubber coating to better protect the material being processed (e.g. gypsum plasterboard).

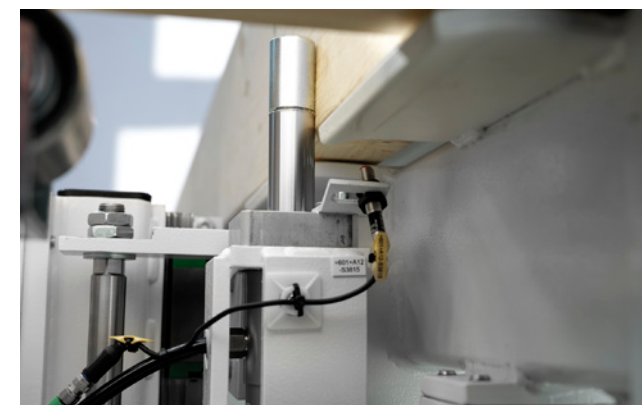
**CLAMPING SYSTEM**

for the first handle on the X stop The pneumatic clamping unit guarantees precise clamping of the first handle regardless of the element size. This ensures maximum accuracy in your production.

**BOTTOM PLATE CLAMP IN Y DIRECTION**

Open elements can be clamped securely regardless of the wall height. This requires no additional setup time at the table.

**NC-CONTROLLED STUD ALIGNER IN X DIRECTION**

Ensures high precision.

BUILDTEQ A-500 setup and distribution trolley

Ergonomic transport of wall elements

The setup and distribution trolley is ideal for use in production lines. It transports wall elements between different workstations and enables easy storage in the wall slot. For this purpose, the element on the trolley is transported to the appropriate wall slot system and then manually pushed out of the setup and distribution trolley and into the storage location.

How you benefit:

- Horizontal element transport and hydraulic setup function
- Transverse chassis for moving to the correct wall slot system
- Comprehensive safety equipment for safe element transport
- With either wall trolleys or loose rollers to feed in the setup elements
- Controlled either directly on the setup and distribution trolleys or via decentralized control points
- Interlinking with the complete production line and fully automatic movement is available as an option



BUILDTEQ A-600 roof and floor table

Specialist for roof and ceiling elements

The BUILDTEQ A-600 enables roof and floor elements to be manufactured quickly and easily. The result is completely rectangular and correctly mounted elements. Using the NC-controlled clamping system, the beam positions are specified automatically based on the CAD data and the beams are clamped. If the table is integrated into a production line, the elements can also be transported, installed and turned. The fully automated setup process for the table is performed only during non-productive time, meaning that there is no waiting time between two elements.



Standard features

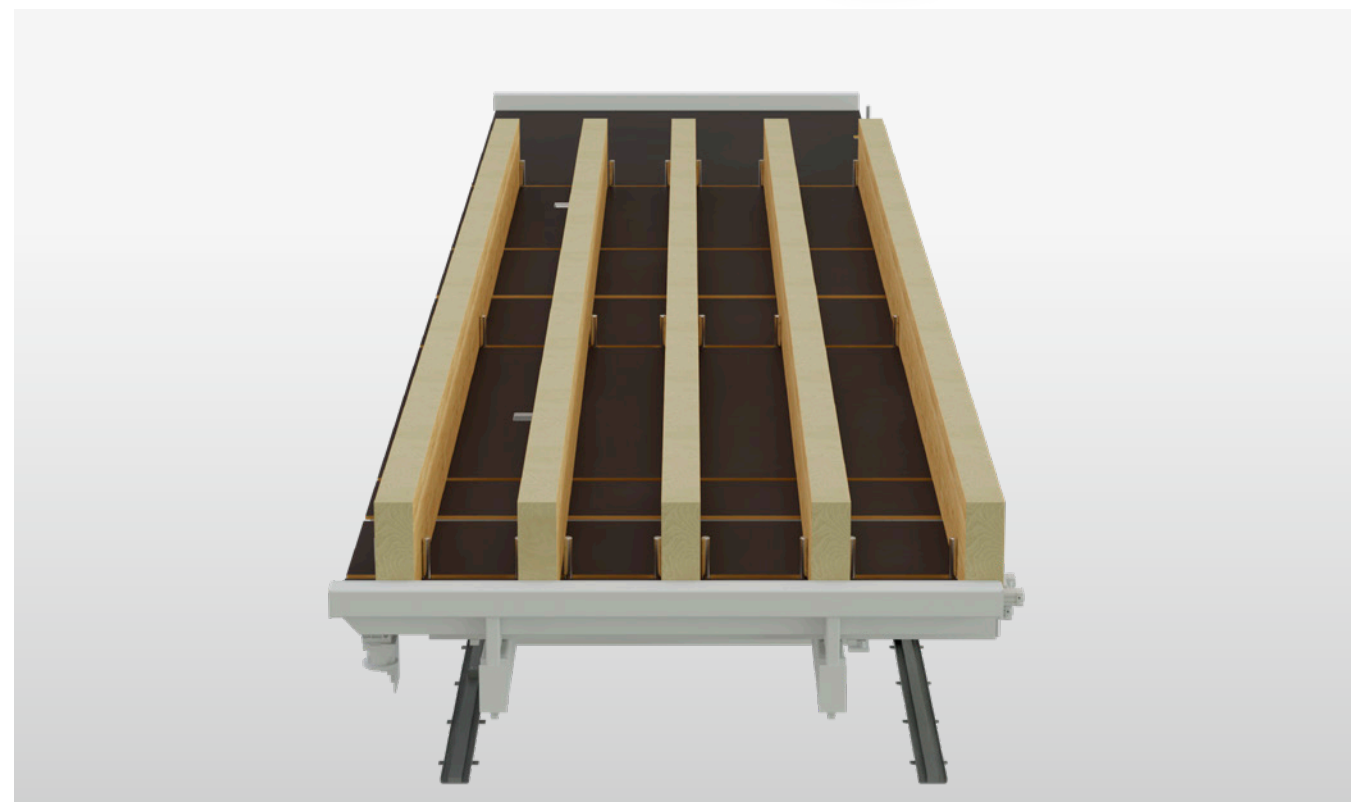

X STOP

Manufacture rectangular elements with the X stop.

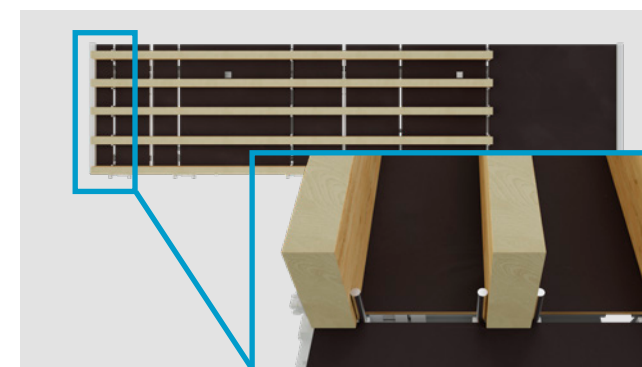

NC-CONTROLLED CLAMPING SYSTEM

Enables fully automatic clamping and alignment of beams.

- Up to six individual beams can be clamped
- Suitable for beam widths from 50–170 mm
- NC axes allow precise positioning of beams
- NC-controlled clamping system with clamping optimization: Synchronous creation of clamping pairs for the complete beam layer in a very short time

Options

HYDRAULIC TILT FUNCTION

Tilts and turns the elements.



INTEGRATED ELEMENT EJECTOR

The element is pneumatically pushed out of the clamping units during the turning operation.

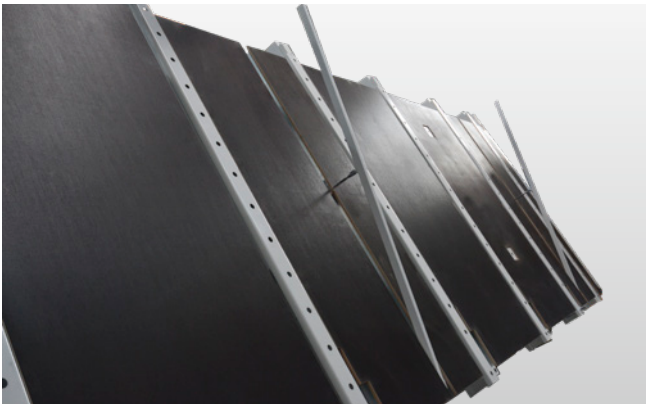

LONGITUDINAL/TRANSVERSE CHASSIS

Chassis in the longitudinal or transverse direction enable integration in a production line.

1 Transverse direction

2 Longitudinal direction

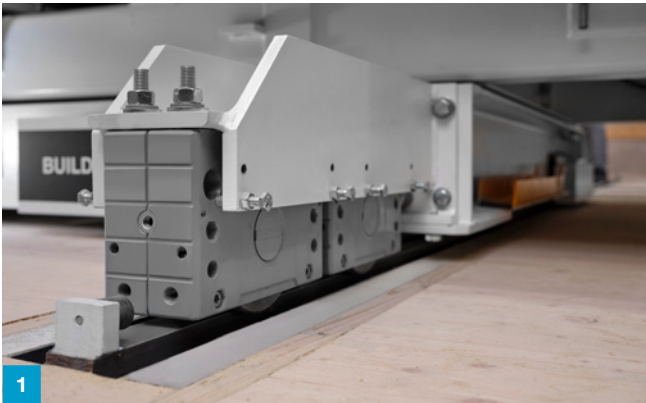

Software

wupWorks 3 software automatically converts WUP files created in a CAD program into CNC programs. The corresponding data is displayed graphically as a 3D model. Work preparation is optimized with the wupWorks Office and wupEditor Office software packages. The woodScout diagnostic system enables systematic troubleshooting and increases machine availability. The MMR Basic, Professional and Office software module can also be used. The BUILDTEQ A-600 is also tapio-ready. The entire clamping system is actuated automatically using the Homatic PLC system PC23Li. The NC-controlled units clamp and position the axes and clamping pairs fully automatically.

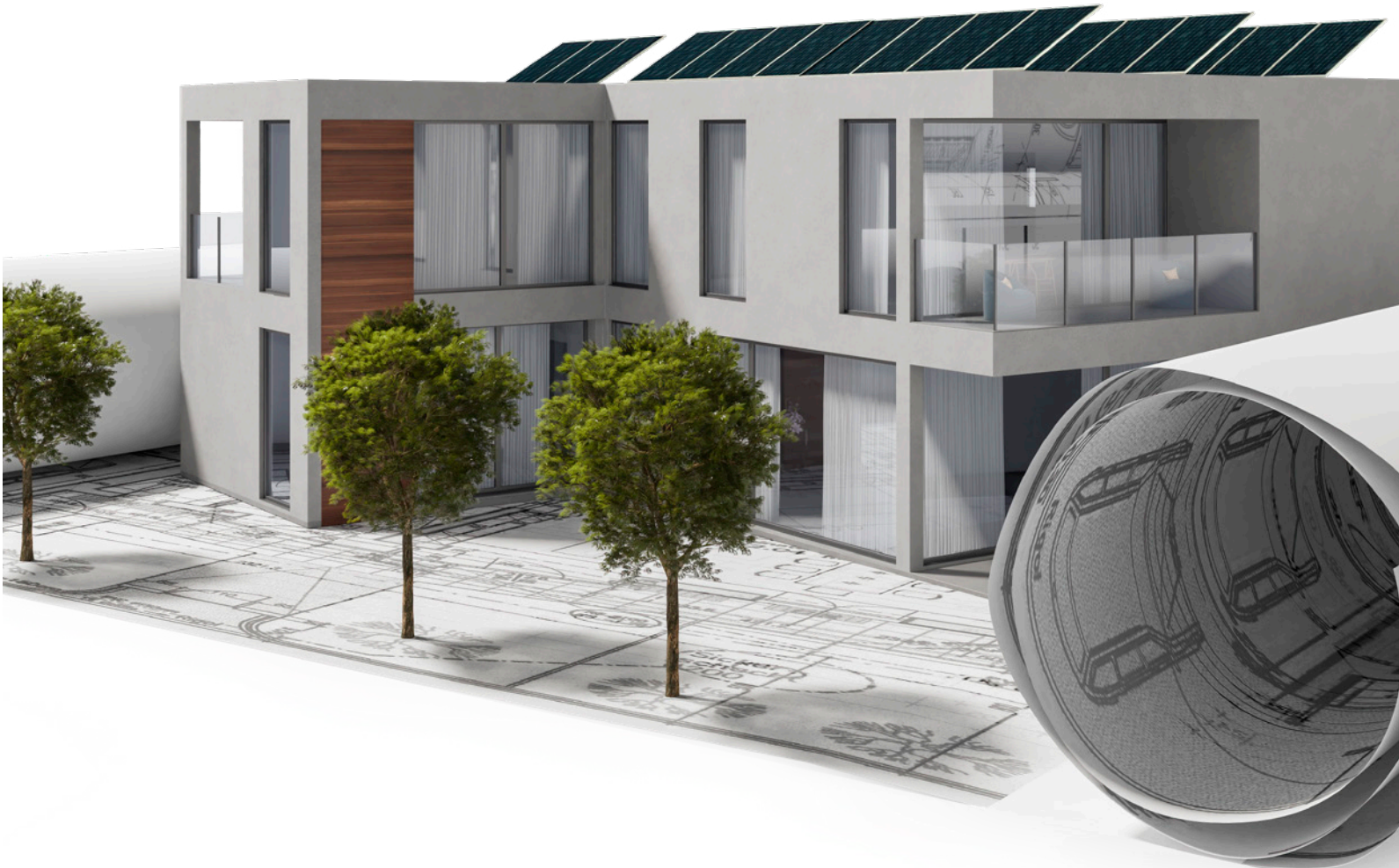
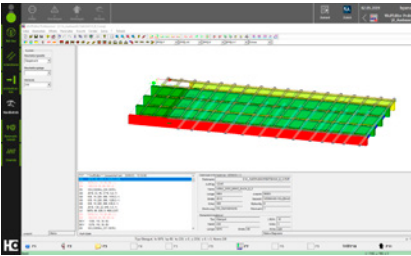

Control technology for assembly tables in industrial production

BUILDTEQ A-600 element tables are equipped with special control concepts. These allow the clamps, stops, chassis, hydraulics as well as the turning and transport operations to be actuated automatically. When the element tables are used in production lines, they are fully interlinked.

Various operating concepts/systems



Local control panel
With complete control system.



Pendant control panel (attached to the table flexibly)
The control system is integrated into the table.



Via wupWorks 3
The CAD data is converted fully automatically and transferred to the machine.

BUTTERFLY TURNING TABLE CONTROL SYSTEM

- Fixed control panel with a view of the tables
- Additional decentralized control panel for controlling the travel functions
- Two movable pendant control panels on the tables for the turning operation

PRODUCTION LINE CONTROL SYSTEM

- For production lines with a maximum of six element tables and complex requirements
- Division into different control circuits possible
- Option to connect data records
- All standard functions such as clamp, stop, chassis, hydraulics, turning and transport can be controlled
- Extended diagnostic options: Own remote diagnostics
- tapio-ready

Highlights

- All machines are interlinked, which simplifies operation
- The safety systems are also interlinked, ensuring an extremely safe working environment
- Control of the turning and travel functions
- The function sequences are automated, and all functions can also be controlled individually
- Identical control over all tables and other WEINMANN products
- Standard online remote diagnostics possible

Product range

BUILDTEQ A-100

Assembly table as a flat-pack solution: We provide you with easy-to-understand assembly instructions, the required technology and a video guide. This allows you to set up the table yourself in no time. Ideal as an entry-level solution.

BUILDTEQ A-300

Insert table for universal use with all wood frame elements. Can be individually supplemented with a wide range of options. Optimal for small and medium-sized carpentry businesses.

BUILDTEQ A-500

Element table with integrated transport system, which is ideal for use in production lines thanks to its flexible and customizable configuration options.

BUILDTEQ A-600

Special table for roof and floor production with NC-controlled clamping system. The table uses CAD data to specify the position of the beams fully automatically and clamps them securely.



OPTION:
BUILDTEQ A-500 compatible with WEINMANN wall slots

Technical data

Assembly tables for woodworking shops

TABLE DIMENSIONS	BUILDTEQ A-100	BUILDTEQ A-300
1 Length (m)	6.2/8.3/10.1/12.1	6.2/8.2/10.2/12.2
2 Width (m)	3	Customer-specific
3 Processing height (m)	Customer-specific	Customer-specific
Clamping range (m)	0.4–3.8	0.4–3.8
Sheathed clamping range (m)	0.4–2.6	0.4–3.8
Weight approx. (t)	0.6/0.7/0.8/1	Customer-specific

PRODUCT DIMENSIONS	BUILDTEQ A-100	BUILDTEQ A-300
Min. element length (m)	Variable	2
Max. element length (m)	6/8/10/12	6/8/10/12
Min. element width (m)	0.4	0.4
Max. element width (m)	3.8	3.8
Max. element weight (t)	3.5	3.5

TABLE DIMENSIONS	BUILDTEQ A-500	BUILDTEQ A-600
1 Length (m)	6.2/8.2/10.2/12.2	
2 Width (m)	3.4–4.0	3
3 Processing height (m)	0.7	
Clamping range (m)	1.2–3.2 Optionally up to 3.8	0.6–2.6 Optionally up to 3
Sheathed clamping range (m)	Optional	Up to 3
Weight approx. (t)	Customer-specific	5.5/6/6.5/7

PRODUCT DIMENSIONS	BUILDTEQ A-500	BUILDTEQ A-600
Min. element length (m)	2	2
Max. element length (m)	6/8/10/12	
Min. element width (m)	1.2	0.6
Max. element width (m)	3.2 optionally up to 3.8	3
Max. element weight (t)	3.5	3.5

BUILDTEQ A-300

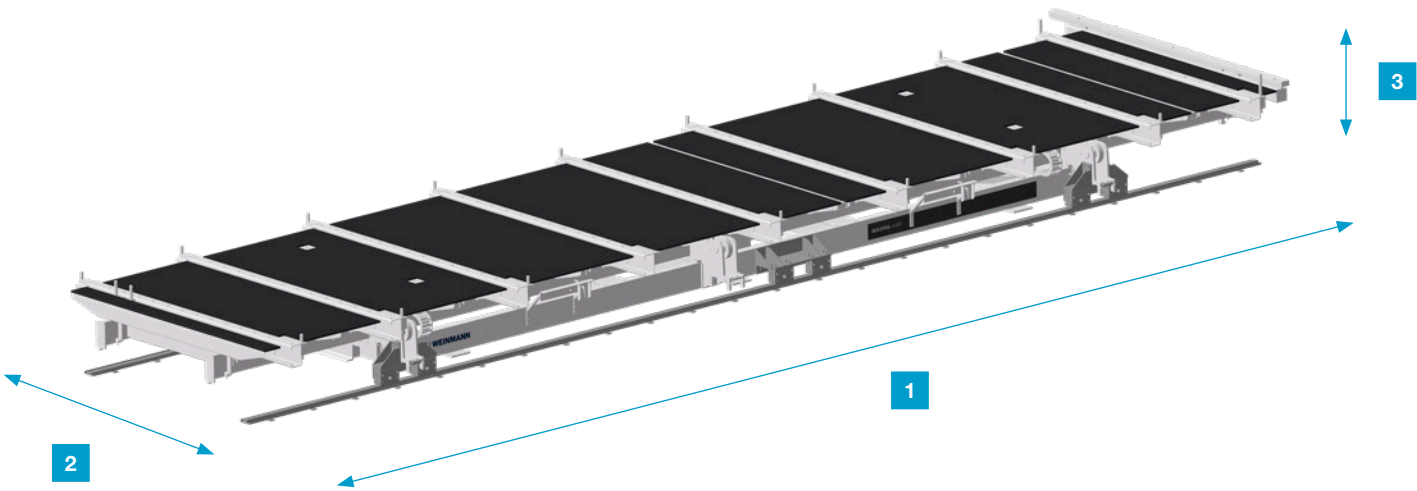

BUILDTEQ A-500

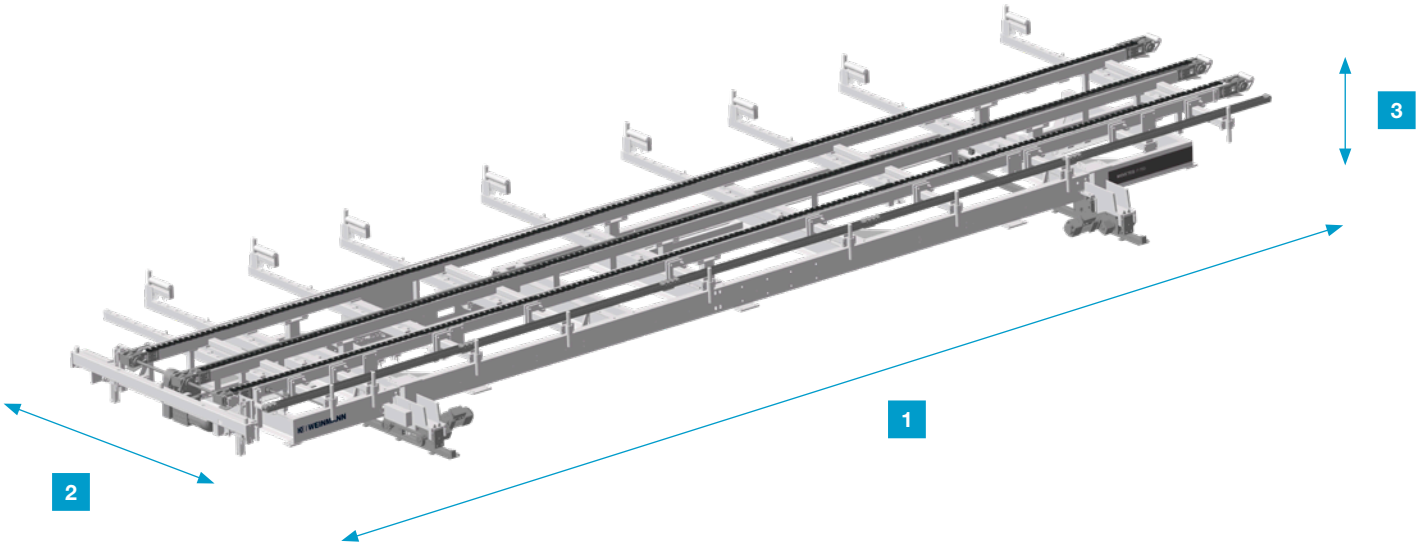

LIFE CYCLE SERVICES

Improved performance, more efficient processes, faster help, assurance of availability and smarter working

TEAM & COVERAGE

Largest global service network in the industry with over 1,350 personnel.

INSTALLATION & COMMISSIONING

For a smooth start, we only let proven experts manage your setup.

OPERATION & CONTROL

After teaching your personnel the intuitive control system, our clever apps help to make the operator's life much easier.

MAINTENANCE & SERVICING

To keep things running, we're happy to take a preventative approach. You decide how often and how intensively you want the support to be. As we all know, prevention is better than the cure.

eSHOP & ONLINE ADVANTAGE

A few clicks and it's fixed. Receive exclusive advantages by ordering spare parts online, depending on market availability. shop.homag.com

HOTLINE & READINESS

When there's an emergency, we're here. Direct by phone, digitally via app or video, or with on-site support. We are close to you with over 90 regional service organizations worldwide. With more than 35,000 spare parts immediately available, we can deliver 85% of your orders fast.

TRAINING & EDUCATION

With classroom, live online or eLearning training, we offer flexible options to help you get knowledge. We conduct over 4,000 customer training courses every year, and we even have our own training centers in 19 countries

MODERNIZATION & IMPROVEMENT

Our modernization program is tailored to your machines and processes. We can evaluate your data and situation and advise you on the next step.

ANALYSIS & SUSTAINABILITY

On request, we analyze all your processes with proven tools and procedures (LeanSixSigma). We have a large, certified team of experts for this purpose.

FINANCING & CONSULTING

We offer you tailor-made financing concepts worldwide. With more than 60 years of experience and a close partner network of prominent banks and insurance companies to help us to find the right solution for you, we're always transparent and reliable in processing.

Fast support:

94% resolution rate via our hotline

Close to you:

1,350 service experts worldwide

We get things moving:

Over 1,000 worldwide spare parts shipments each day

No one else has that:

Electronic documentation on over 150,000 machines, available in 28 languages

The WEINMANN ACADEMY

With our help, you can simply be better than the rest.

Maximum productivity requires technological and trade expertise. The best way to increase your operational efficiency and output is through optimally trained employees. In addition to training courses for your new machine or software, we also offer further training and qualifications. We are constantly improving our training courses and tailor them individually to your requirements – so you are optimally prepared for current and future challenges.

PREPARATION

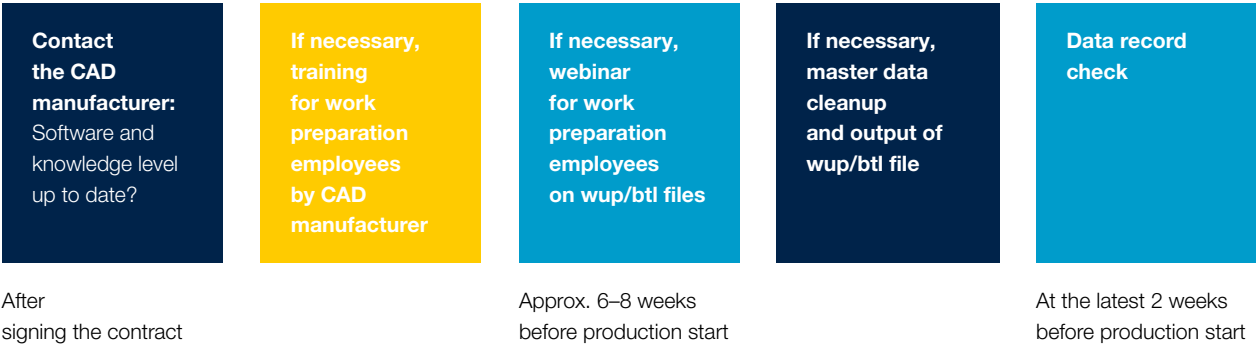

PRODUCTION START



FOLLOW-UP



- Customer service
- CAD manufacturer offer
- WEINMANN Academy offer

WEINMANN Academy
[Learn more](#)

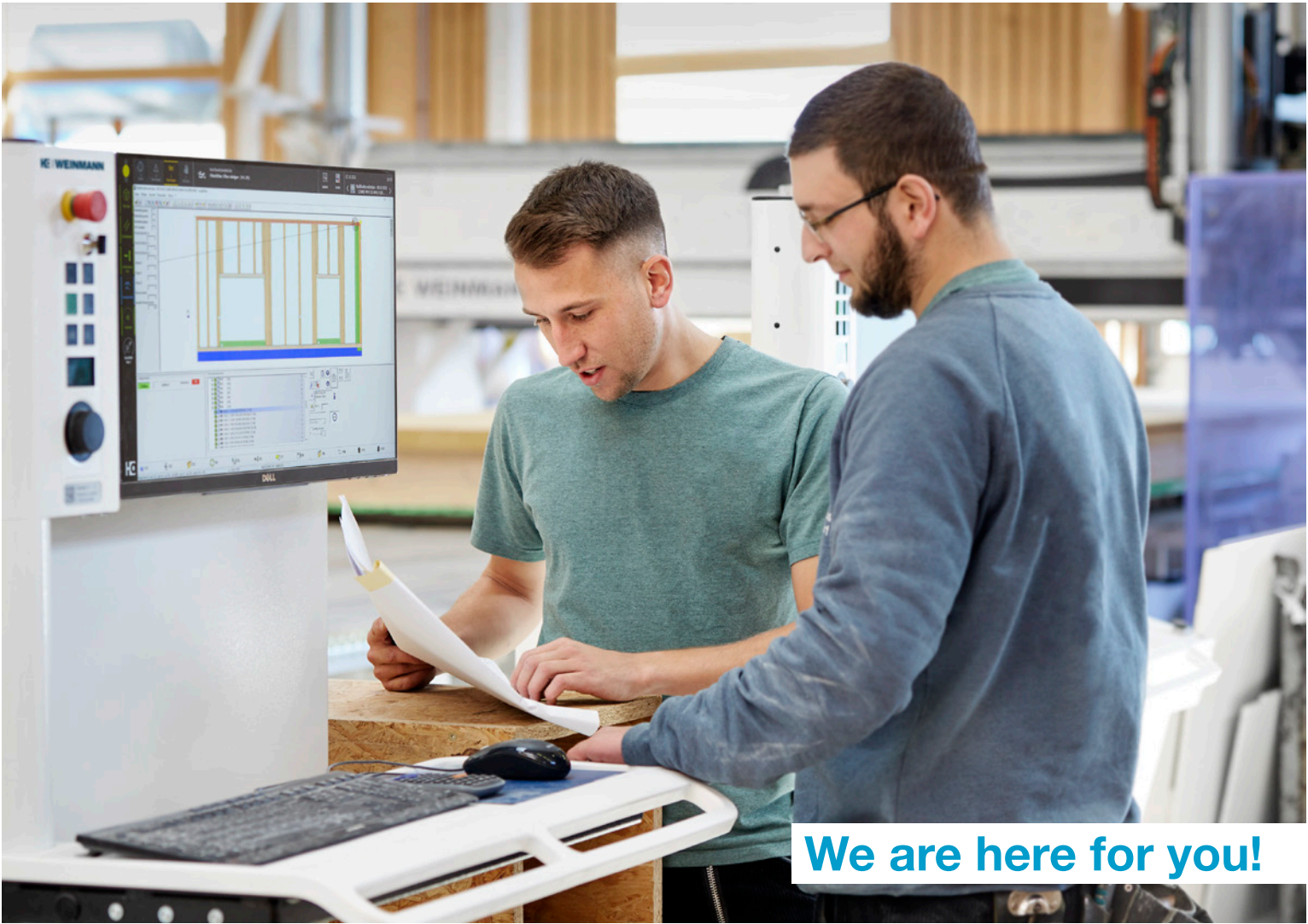

We are here for you!

SCHULER Consulting:

Strategies for practice

Competent, professional, cooperative.
For more than 65 years, we have been firmly rooted in the furniture industry and timber construction. We provide holistic support on your way to success. We are experts in our field: Our core competencies lie in strategic production development, production

optimization, information flow consulting and Industry 4.0. We are strategists, planners, creative thinkers and tireless creators. We apply our expertise to your success. We are only satisfied once we have found the best solution for you. Your corporate vision is always the key focus. You too can benefit from our expertise.



OUR APPROACH

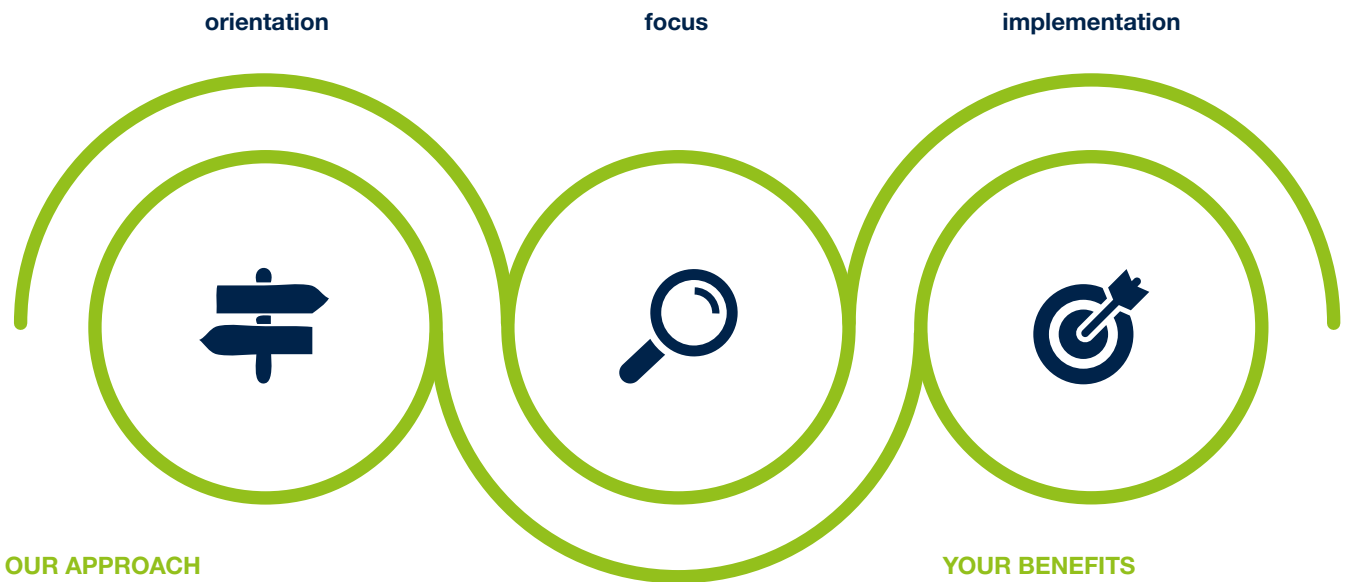

OUR APPROACH
Where is my company today?

POSSIBLE FOCUS POINTS
What optimization potential is there?

YOUR BENEFITS
What takes priority? Suggestions for the further development of your company



PRODUCTION OPTIMIZATION POWER WORKSHOP

Specific strategies for immediate implementation.

Continuous growth and changes in objectives and framework conditions are often accompanied by the further development of established structures. Together, we develop an action concept on site that is tailored to your company objectives, processes, production and organization. We also use methods and strategies such as OEE and Lean

Six Sigma. Our objective is to identify potential for increasing efficiency and increasing performance. The Production Optimization Power Workshop is your basis for taking suitable measures and precisely aligning your company for the long term. For example, a possible focus could be planning your optimal material and production flow.

- Your benefits**
- Immediate implementation of improvements
 - Timetable with specific optimization strategies (short, medium and long term)
 - Balancing effort and benefits

Practical example: Improving the production flow through intermediate storage.



INFO
SCHULER
Contact form

On to digital shores!



MORE ATTRACTIVE AND MORE EFFICIENT WORKPLACES THROUGH OPTIMIZATION FOR "LEAN PRODUCTION"

- Reduce waste (material, time, space/area, costs)
- Analysis and reduction process times that do not add value



TARGETED AUTOMATION AND ANALYSIS OF YOUR PROCESSES AND PRODUCTION

- Comprehensive analysis of your company, from the office to the construction site
- Development of a technology concept and recommendations for machine selection



ACTUAL AND TARGET ANALYSIS AS THE BASIS FOR DIGITALIZING YOUR INTERNAL COMPANY PROCESSES

- Software consulting for work preparation
- Strategic roadmap for your digitalization



Digitalization in timber construction

Targeted and successful implementation



We analyze the relevant core processes in your company and give you targeted recommendations on how to break the vicious cycle of the shortage of skilled workers. Together, we are paving the way for meaningful digitalization and

automation. The result? You benefit from competitive advantages in terms of productivity, efficiency and quality and create attractive jobs within your company.



RECOMMENDATIONS FOR STRUCTURING AND OPTIMIZING YOUR PRODUCTS

Recommendations to improve and standardize your designs to increase automation and manufacturing efficiency



SUPPORT FOR PRODUCT STANDARDIZATION

Recommendations for:

- Construction of the wall, roof and ceiling structures
- Windows and door openings
- Component diversity and dimensions



AUTOMATION AND DIGITALIZATION EXPERTISE

Advice on the appropriate degree of digitalization and automation (what do I need to digitalize? Where does automation make sense?)



WEINMANN Holzbausystemtechnik GmbH

info@weinmann-partner.de
www.homag.com/weinmann

YOUR SOLUTION