

EDGESEQ

S-380 /

S-380 profiLine

The highly flexible allrounder.

Fast feed, powerful, large screen.



Building living spaces.

From furniture to homes: The future is built with wood.

Together, HOMAG, WEINMANN, SYSTEM TM and KALLESOE provide comprehensive production solutions for manufacturers of optimized timber, engineered wood, timber construction, interior fittings, furniture and more. With over 500 years of combined experience in machinery engineering, automation systems, and software technology, our focus is on building strong partnerships that enhance your productivity, precision, and profitability.

This is how we are Building living spaces. Together, with you.

HOMAG – YOUR SOLUTION



High-precision edge banding solutions.

The edge largely determines the quality of furniture. This means it has to be perfect – without manual reworking. With an edge banding machine from HOMAG, your perfect zero joint becomes standard. Whether laser edging, airTec or PUR glue: We have the right solution for joiners who value immaculate precision.

To ensure that your individual furniture transforms rooms into living spaces in the future, too.

Building living spaces.

Building precision.

Your edge on quality.





Rediscover your competitive edge.

Perfect edges produced with flexible machines for demanding customers

Individual customer requirements, sophisticated products and a wide range of materials — these are all requirements that play a key role in today's wood processing sector. It is therefore important that production is flexible and efficient, especially in woodworking shops and for medium-sized businesses.

HOMAG offers you unbeatable advantages, has an international production network as well as sales and service companies, with a presence in more than 100 countries and around 7000 employees. HOMAG can help make your business competitive and ensure lasting business success.

YOUR SOLUTION

[MORE AT HOMAG.COM](https://www.homag.com)



CONTENTS

- 06 The most important features
- 10 EDGETEQ S-380 | S-380 profilLine series
- 18 Our unit modules
- 35 LOOPTEQ return
- 38 EDGETEQ S-380 profilLine
- 40 Apps and digital assistants | Software
- 47 Control with powerTouch
- 48 Technical data
- 50 Life Cycle Services

You can choose between eleven models and the freely configurable profilLine

THE MOST IMPORTANT FEATURES

What distinguishes the series is the extensive equipment, including a belt top roll pressure unit for precise workpiece guidance, as well as optimized trimming tools for optimum chip removal and perfect processing quality. A variable feed rate for different performance classes ensures a high level of productivity. In addition, all machines can be extended.

THE EDGETEQ S-380 PROFILINE offers additional units in comparison to the preconfigured models and can also be freely equipped from the extensive unit modules.

Machines in the EDGETEQ S-380 series are energy efficient and environmentally friendly.

- **High-quality furniture with high-quality edges**
- **More output due to high availability**
- **Low energy requirements**
- **High levels of efficiency**
- **Optimum price/performance ratio**



Intuitive operation with the powerTouch control system

Control machine functions directly using the multi-touch monitor in widescreen format. The ergonomic design and numerous help and assistant functions simplify operation significantly.

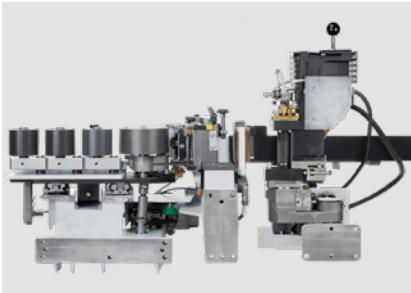

Gluing units for safe hot-melt glue application

HOMAG gluing units are ideal for fast, solid gluing of EVA and PUR. The heated gluing roller ensures an optimal adhesive temperature.

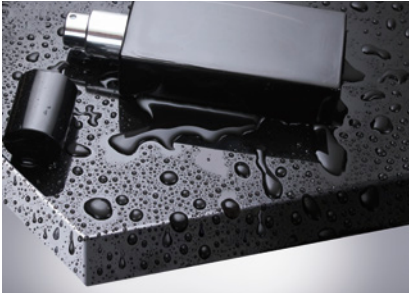

Edge gluing with PUR

At HOMAG, PUR glues are processed on the same machines and with the same application unit as EVA hot-melt glues.

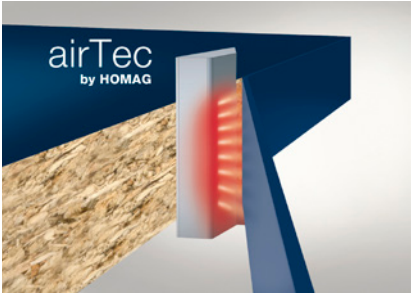

Zero joint technology with HOMAG airTec

The units are now equipped with a rotary fan heater, which improves the efficiency of the process, reduces noise and ensures a more cost-effective use of resources.



Belt top roll pressure unit

The steel top roll pressure unit with double V-belt provides the basis for the highest quality because your workpieces are optimally clamped for processing.



Multi-profile technology

For easy adjustment of the units at the touch of a button. Saves time and increases quality.

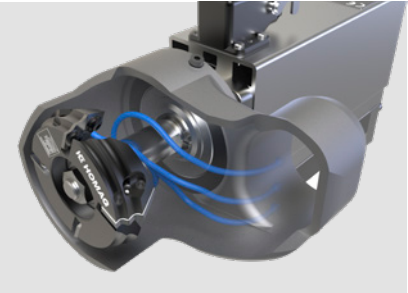

Controlled chip collection



The chips are suctioned up in the interior and fed to the extraction hood in a targeted manner. Reduced wear and tear and lower service costs increase profitability and service life. The reduced suction speed lowers energy consumption and costs.



Material types | Edge parameters

A high level of flexibility is achieved through the processing of all types of edge materials: 0.3-mm melamine, 3-mm ABS/PVC, 20-mm solid strip and veneer. For perfect high-gloss parts, important components such as the motorized top roll pressure unit and the automatic adjustment of the glue joint scrapers are used. Special tracing elements are ideal for processing sharp-angled or blunt-angled parts or parts with hinge holes.

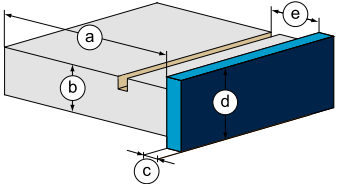
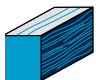

| | | | a | b | c | d | e |
|-------------------------------------------------------------------------------------|------------------------|-------------------------------------------------------------------------------------|-------------------------------------------------------|------|--------------------------------------------------|----|---------|
|  | SOLID (mm) |  | If $b \leq 22$: min. 60 If $b \leq 40$: min. 125 | 8–60 | 0,4 – 12,0 (15) 0,4 – 20,0 (profilLine) | 65 | Max. 30 |
| | ROLLERS (mm) |  | | | 0.3–3.0 | | |
| | STRIPS (mm) |  | | | 0.4–3.0 | | |



Increased productivity for your edge banding machine

NEW: Optimize your production with the new LOOPTEQ O-400! By combining a stacking system with a workpiece return, your production process will be taken to a new level. The high automation of the edge banding machine enables quick and easy removal or stacking of finished parts and ensures smooth workflows.

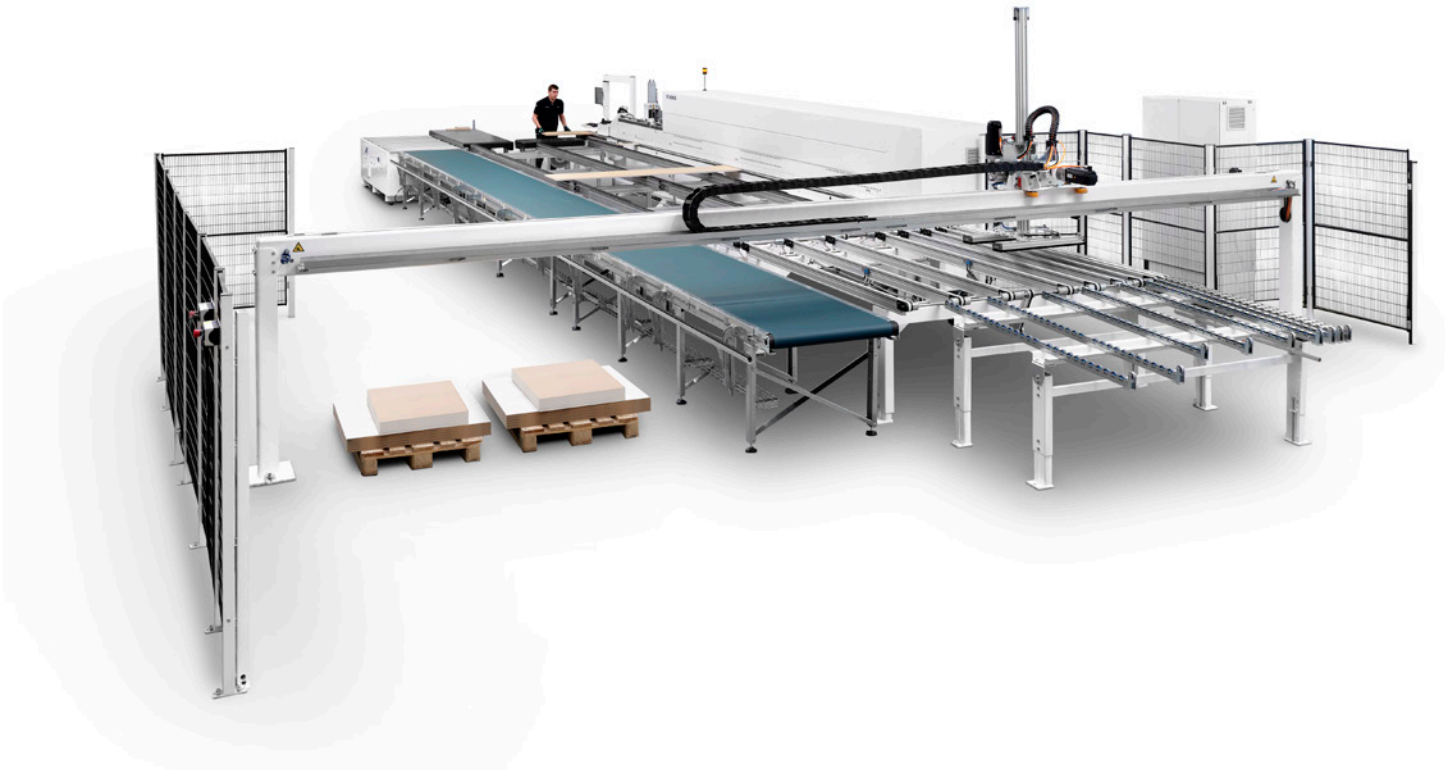



EDGETEQ S-380

Model 1650 FC

Feed speed: 8–18 m/min (optional: 20)

- 1 Joint trimming unit
- 2 Gluing unit
- 3 Snipping unit
- 4 Trimming unit
- 5 Profile trimming unit
- 6 Profile scraper
- 7 Glue joint scraper
- 8 Buffing unit

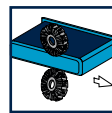
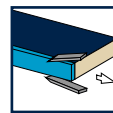
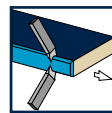
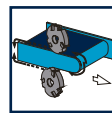
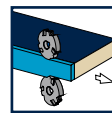
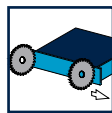
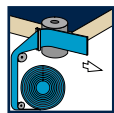
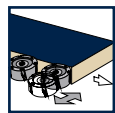

EDGETEQ S-380

Models 1650 FC | 1670 FGC:

Setting standards for performance and quality

The basic machine is equipped with a precise gluing station, a dual-motor snipping unit, a trimmer and a profile trimming unit. A radius scraper, a glue joint scraper and a buffing unit provide the perfect finish. The powerful motors of all units provide the unrestricted power required for processing the wide range of parts. In order to always be in a position to offer

the optimum solution, a joint trimming unit and a swiveling grooving unit (1670 FGC) are available for the machines. Thanks to the optional Quickmelt gluing station, the optional workpiece gap optimization for even more effective production and the available separating and cleaning agents, this series is optimally equipped for all requirements.



EDGETEQ S-380 — 1660 FGC model

This model contains the same equipment as the 1650 FC model, with the addition of a grooving unit and a safety pressure device.



EDGETEQ S-380

Model 1650 HF

Feed speed: 8–18 m/min (Optional 20)

- 1 Joint trimming unit
- 2 Gluing unit
- 3 Snipping unit
- 4 Pre-trimming unit
- 5 Multifunction profile trimming unit
- 6 Profile scraper
- 7 Glue joint scraper
- 8 Buffing unit

EDGETEQ S-380 — 1650 HF and 1660 HF models: Precision and performance for high demands

The basic machine is equipped with a precision gluing station, a dual-motor snipping unit, a trimmer and a multifunction profile trimming unit for corner rounding and flush trimming. A radius scraper and a buffing unit provide the perfect finish. The powerful motors of all units provide the unrestricted power required for processing the wide range of parts. In order to

always be in a position to offer the optimum solution, a joint trimming unit and a glue joint scraper are available as standard for these machines. The Highflex series is distinguished by its high level of automation and the extensive unit equipment. The high level of flexibility allows the machines to be aligned to your needs and guarantees optimal edges.



EDGETEQ S-380 — 1660 HF model

This model contains the same equipment as the 1650 HF model, with the addition of a fine trimming unit.

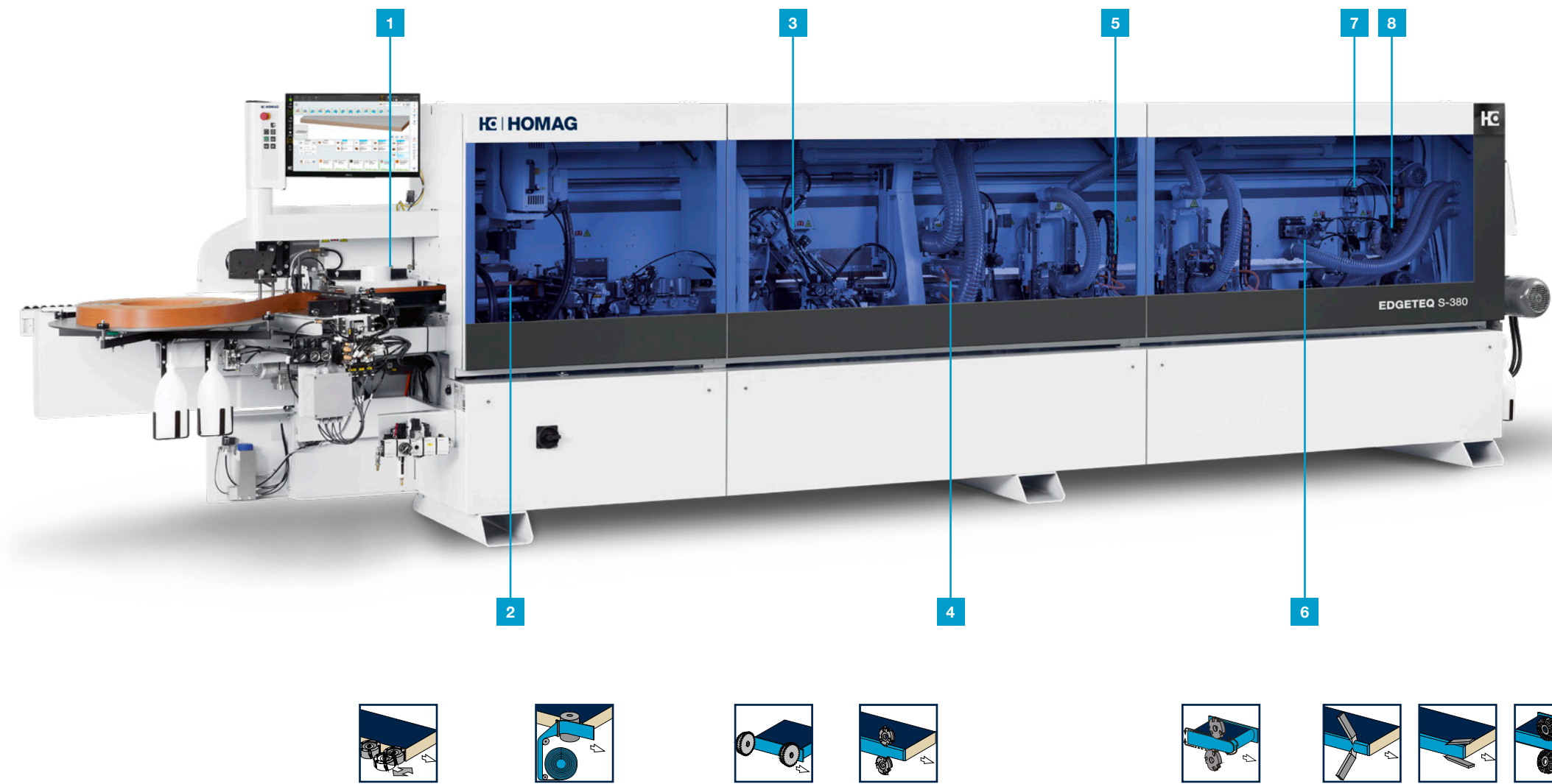

EDGETEQ S-380

1650 E model

Feed speed: 8–18 m/min (Optional 20)

- 1 Joint trimming unit
- 2 Gluing unit
- 3 Snipping unit
- 4 multi-level trimming unit
- 5 Profile trimming unit
- 6 Multi-level scraper unit
- 7 Glue joint scraper
- 8 Buffing unit

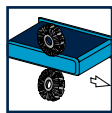
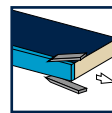
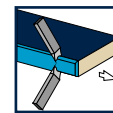
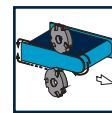
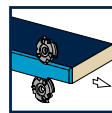
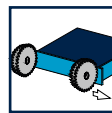
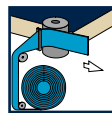
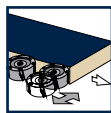

EDGETEQ S-380 — 1650 E–1660 E models:
The powerful compact class

The Edition models already offer a high degree of automation in the standard features and the simple processing of several radii in the standard version. The basic versions are equipped with a joint trimming unit, a precision gluing station, a dual-motor snipping unit, a multi-level trimmer and a profile trimming unit. A multi-level scraper, a glue joint scraper and a

buffing unit provide the perfect finish. The Edition models are distinguished by their high level of automation. The multi-level trimming unit and the multi-level scraper always offer the optimum radius for frequently changing applications, and therefore the best results.



EDGETEQ S-380 — 1660 E model
This model contains the same equipment as the 1650 E model, with four-motor profile trimming unit.

EDGETEQ S-380 profiLine:

The best results with any edge material

The EDGETEQ S-380 profiLine series offers a versatile range of products for precisely positioned gluing of edges in the best HOMAG quality. The machines are available in different machine lengths that can be integrated into any production

environment. Thanks to the individual configuration with a number of units, you can use the machines for a wide variety of production tasks.



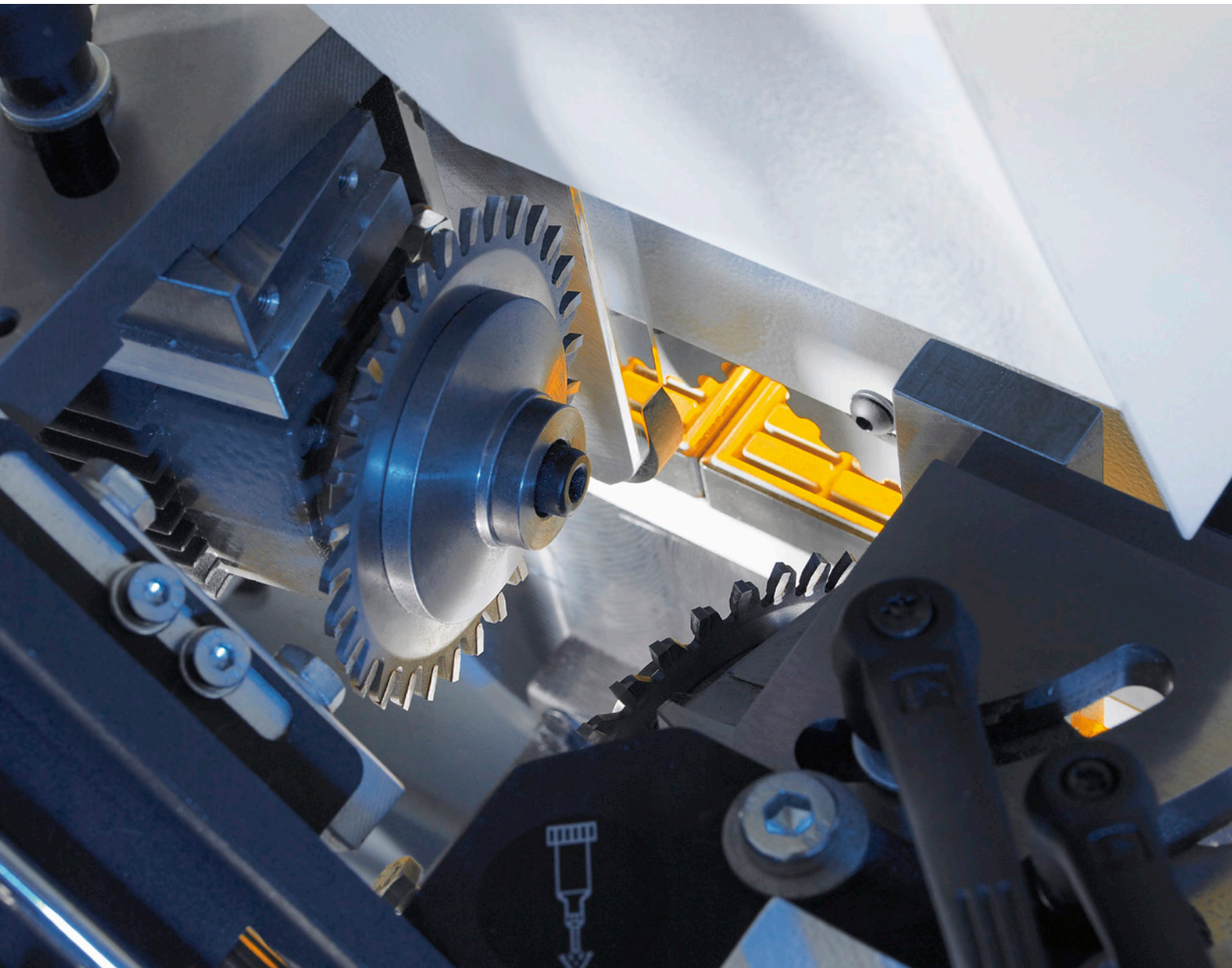

Our unit modules: The right solution, whatever the requirement

For wide-ranging and diverse processing tasks, we use units from our tried-and-tested unit modules. We are constantly expanding our functions so we can offer you the right solution for new trends. The following pages contain units from the

fields of joint trimming, gluing, cutting, trimming, grooving and finishing. You benefit from a high level of precision, state-of-the-art technology and the ability to produce your products flexibly and efficiently.

Guiding the workpieces

Workpieces need to be fed into machines precisely in order to achieve perfect edge quality. Take advantage of the benefits our solutions have to offer, such as infeed guides, infeed blocks, sliding carriages and workpiece supports.



Infeed block

For a minimum workpiece distance and safe operation.



Automatic adjustment of the infeed guide

Program-controlled, precise and repeatedly accurate adjustment of the infeed guide via the infinitely variable axis.



NEW!

Air cushion table

Air cushion table for safe loading of the machine.



NEW!

Air cushion table at outfeed

Available in combination with the infeed table, size: 1275 x 650 mm

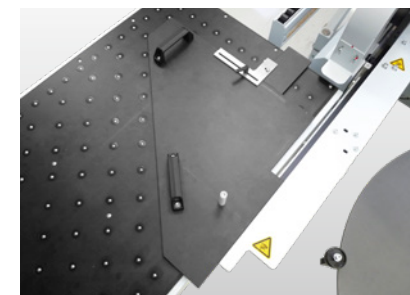

Feed system for small parts

For easy equipping of the machine for small workpieces.



Sliding carriage

Robust linear guide for feeding the workpieces in at a right angle.

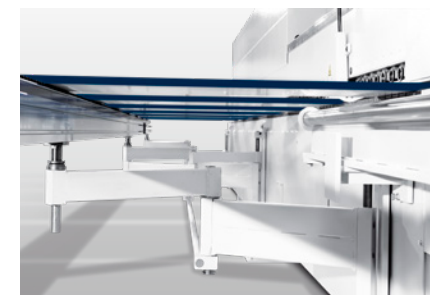

Workpiece support in scissor design

Due to the scissor design, the workpiece support can be comfortably extended up to 1000 mm.

Sprayers

Sprayers improve the edge quality throughout processing. Separating agents prevent hot-melt glue residues forming deposits and anti-static agents prevent plastic chips forming deposits.

The adhesive residues can be easily removed using cleaning spray. Lubricants prevent shiny marks on the workpieces and protect sensitive surfaces before trimming.

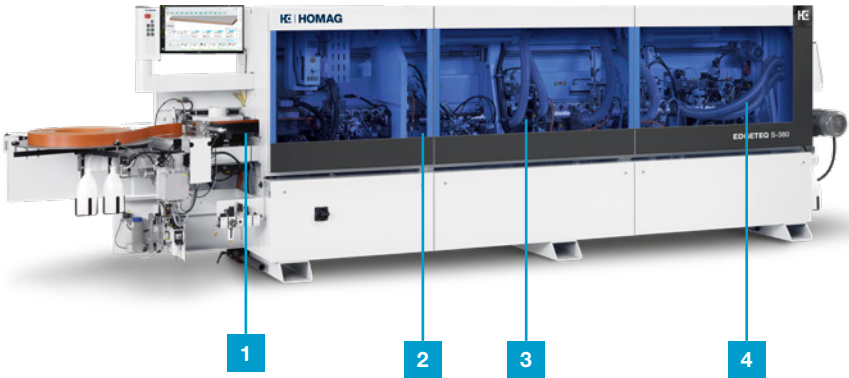

- 1 Separating agent
- 2 Lubricant
- 3 Anti-static agent
- 4 Cleaning agent

Joint trimming unit

Our joint trimming units form the basis for precise, absolutely straight and tear-free workpiece edges and glue joints with consistently high product quality.

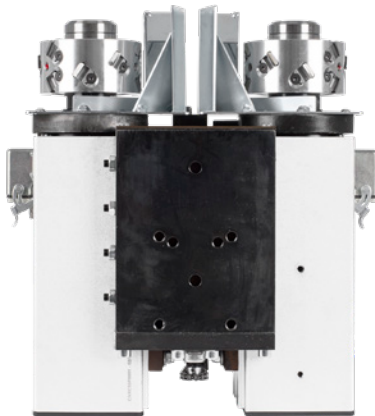

Joint trimming unit
Diamond tools ensure perfect cutting and a long service life, as well as optimal glue joint quality. The diameter is 100 mm.

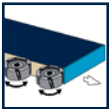

Systematic gluing

For solid gluing, it is crucial to achieve an optimum interplay of very different factors. On HOMAG machines, the workpiece preheating, application unit, quick-release system, melting unit, magazine and pressure zone are perfectly aligned.



Workpiece preheating with heaters
High-strength gluing due to optimum workpiece preheating.

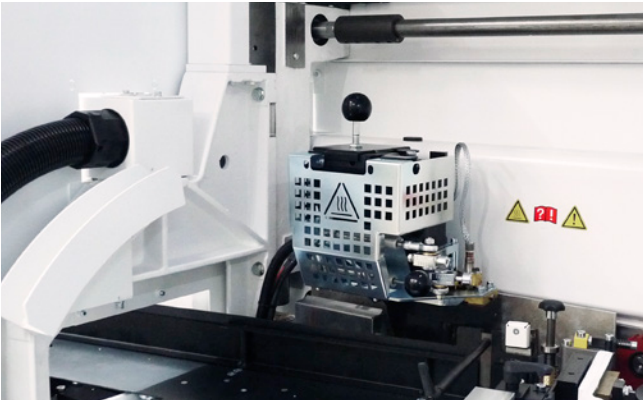

QA65N application unit
For both EVA and PUR.

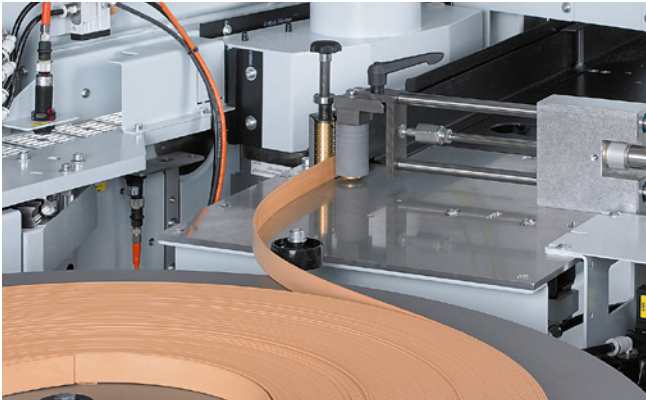

Automatic edge infeed
For quick edge changes between different rolls of material.

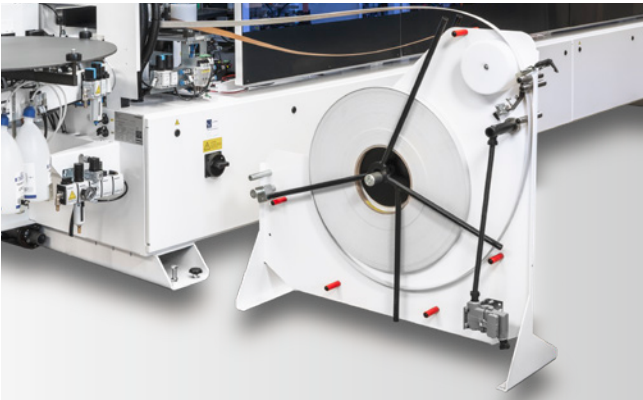

Magazine with two rollers (automatic)
Two edge feeds and two roller mountings for automatic switching between two edges.

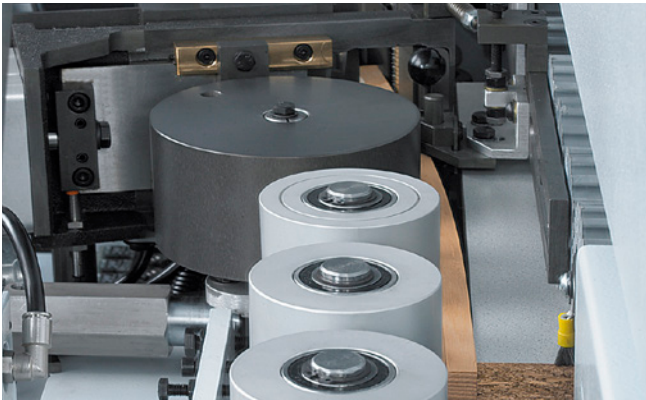

Pressure zone
Heavy pressure zone up to 15/20-mm edge thickness and 60-mm panel height for optimum glue joint quality.

Gluing unit — safe hot-melt glue application

HOMAG gluing units are ideal for quick, solid gluing. The heated gluing roller ensures an optimal adhesive temperature. On request, the gluing unit can be equipped with a melting

unit for you for a high level of availability and optimum gluing quality.

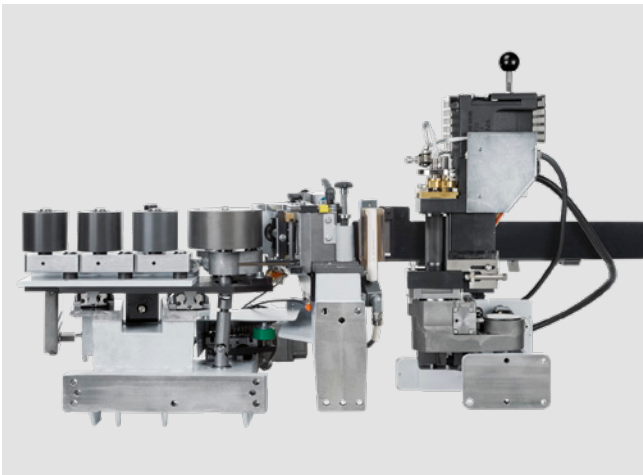

Top gluing unit — QA65N glue application system

The application unit can be easily removed by means of a quick-change device with pneumatic interface.

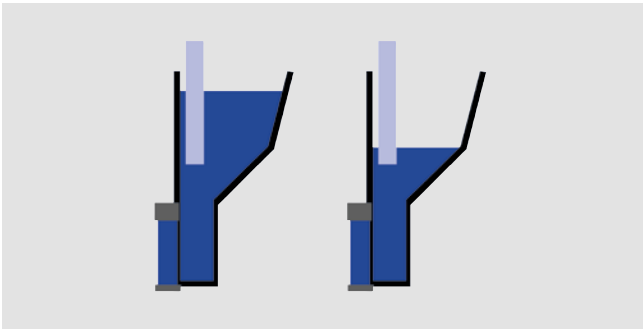

Sensor for checking the fill level of the application unit

Switching to a lower glue level guarantees a fast heat-up time for processing small batch sizes.

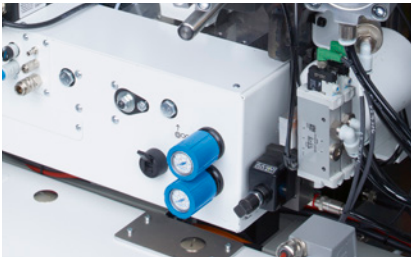

NEW: Magazine height adjustment:

The edge overhang on the underside can be increased by adjusting the magazine plate.

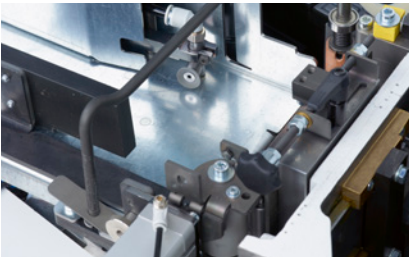

NEW: Strip separation:

The use of a vacuum suction unit allows strips to be separated into thin veneer, HPL or composite strips reliably

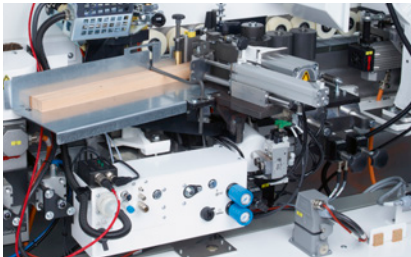

NEW: Servo edge feed:

The direct drive enables a more precise edge position without gears and drive units, which increases the durability and operational safety and reduces the maintenance effort.

YOUR BENEFITS AT A GLANCE

- Short heat-up time thanks to sensor-controlled level regulation (two levels can be selected)
- The application unit can be easily removed thanks to the quick-release lock
- Pre-melting unit for melting hot-melt glue automatically or manually as required
- Gluing roller with integrated heating unit guarantees a constant temperature and viscosity for all workpiece thicknesses
- Electro-pneumatic clamping of the gluing roller and tank prevents glue contamination to the rear edge of the workpiece
- Tracing pad prevents wear to the application roller and ensures a constant glue film thickness
- Gluing roller lifts when feed stops
- Automatic glue quantity metering

More flexibility when melting the glue

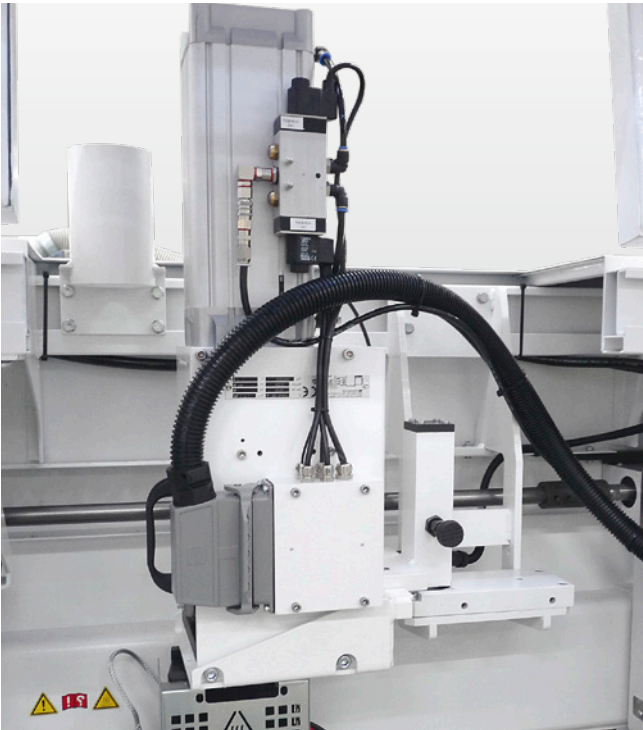

Universal Melting unit in three versions: EVA, PUR as well as EVA and PUR

- Efficient processing, as the glue is pre-melted
- Melting capacity max. 2.5–4 kg/h
- With the combination EVA and PUR, changing the type without cleaning is fast and easy thanks to interchangeable containers



Interchangeable container

Easy to use for EVA and PUR adhesives



Melting unit for EVA

- High availability, as the adhesive is melted only in accordance with adhesive consumption. The Quickmelt system ensures perfect glue quality.
- Melting capacity max. 8 kg/h



Automatic glue quantity metering

The application quantities are implemented quickly and easily via the powerTouch user interface for automatic glue quantity metering. The glue is applied in synchronous operation.

Precisely and quickly adjustable glue quantities result in:

- Optimal gluing quality
- Higher availability and performance
- Greater cost efficiency

PUR glue and HOMAG — a strong connection

Using polyurethane (PUR) hot-melt glue increases the resistance of furniture to moisture and heat. It is ideal for use on furniture in damp areas such as bathrooms, kitchens and laboratories.



Your HOMAG PUR benefits at a glance

- One application unit for all types of adhesive
- No additional application unit required
- Fast, powerful thin-film application by means of gluing roller with integrated heating unit
- To be used as standard from the entry-level model to the high-end machine



Melting unit for PUR

- Melting capacity 6 kg/h
- Temperature regulation to protect against overheating



Vacuum container

- Compact, portable container for the PUR application unit or a PUR melting unit with 2.5 kg/h capacity
- No vacuum pump and no nitrogen necessary



Service station

- Preheating and cleaning station for the QA65N application unit with one storage position
- High level of flexibility thanks to up to two vacuum containers for one QA65N application unit or one PUR melting unit with 2.5 kg/h capacity
- No vacuum pump and no nitrogen necessary
- With optional accessories also for application units for the powerEdge Pro/Pro Duo CNC edge banding unit

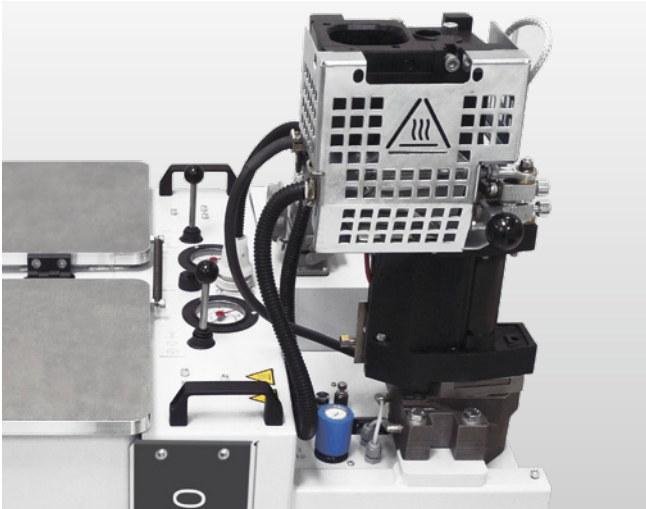

Service station

The application unit in the holding device for preheating

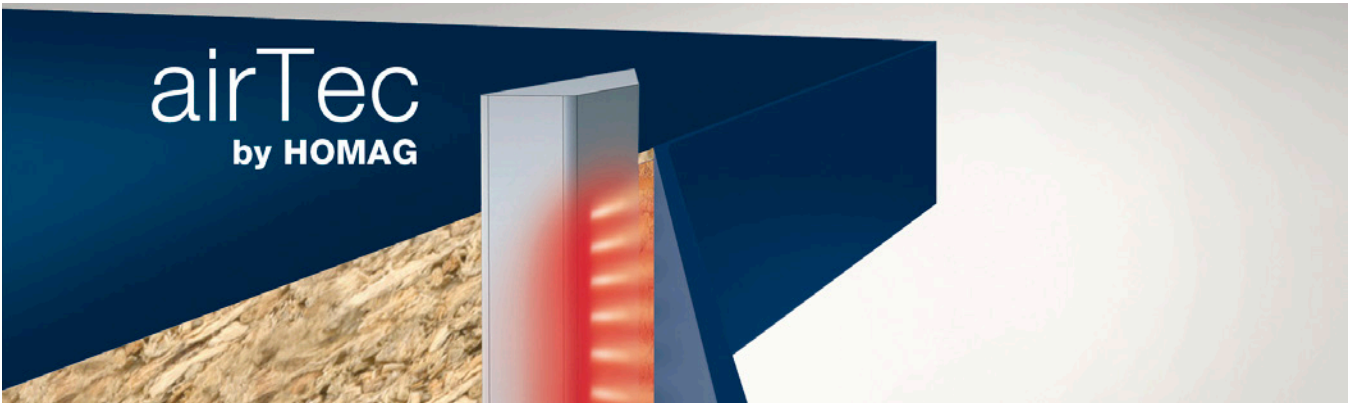

airTec — an ideal introduction to zero joint technology

The airTec process has established itself as the optimum zero joint solution for woodworking shops and medium-sized companies. At the core of the HOMAG airTec unit is a powerful, resource-conserving rotary fan heater, which is

also distinguished by a significantly reduced noise output. All laser-compatible edging types that are currently available on the market can be processed with airTec. This means great flexibility for all materials and colors.



Gluing edges "without joints"

In the airTec process, the edge and panel are bonded using hot air. This requires the use of special edges. These consist of a decorative layer and a functional layer. Using the HOMAG airTec unit, the functional layer is melted at a constant temperature and volume outflow and optimally applied to the narrow surface.

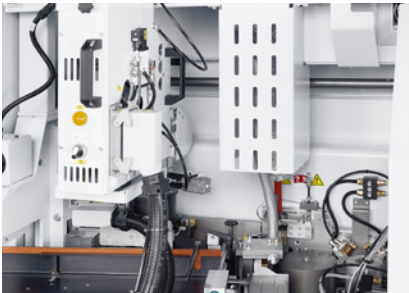

Easy integration

The airTec reactivation unit is installed in such a way that you can work with either the standard application unit or the airTec system. The anti-static spraying device for an optimum processing result is included in the standard version of all airTec units.

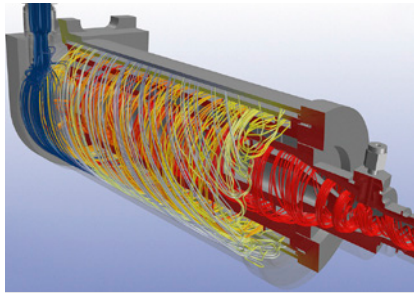

Innovative rotary fan heater

This source of energy heats the air and simultaneously serves as heat storage that can then be used to heat the air again. In addition, less air is required and the heating effect on the surrounding area is minimized. Any noise is almost exclusively produced during the activation process and is below the noise level of other processing units.

Snipping unit for cutting the overhangs on the front sides

For processing the edge overhang on the front and rear edge of the workpiece. The front side can be snipped straight, with chamfer or with overhang.

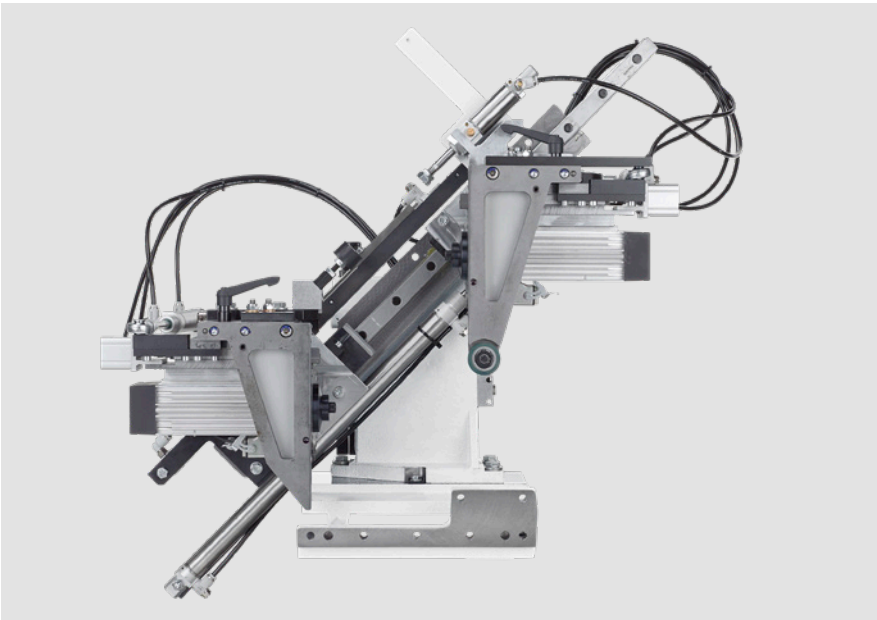

Snipping unit

An exact snipping cut thanks to a robust snipping unit with extremely precise linear guide and workpiece gap optimization (optional) for a higher output in the same processing time. Soft-touch function for optimum snipping results even at high feed speeds.

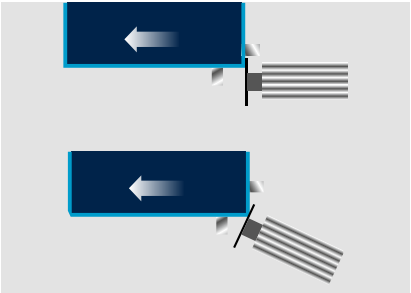
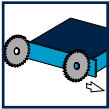

Automation in the standard version

Pneumatic adjustment of the snipping motor for chamfers/straight lines, for a quick change between straight-line snipping and cutting with a chamfer.

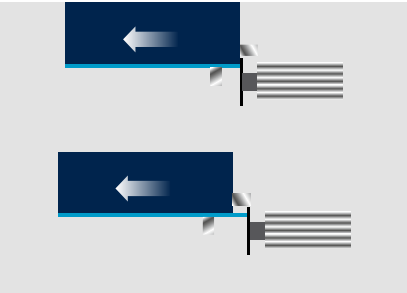

Can be automated

For a quick change between flush snipping, e.g. of solid strips or shelves, and cutting with an overhang for profil trimmig results.

Trimming units for flush trimming

The pre-trimming and fine trimming units offer the perfect solutions for processing edge overhangs. The trimming units are only equipped with tools that collect the chips in a controlled manner.

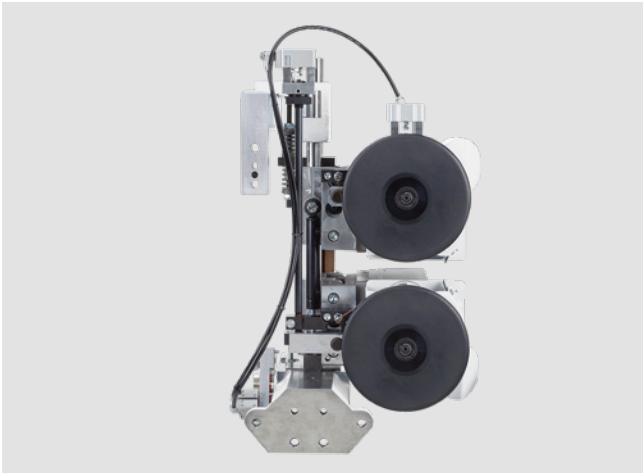

Pre-trimming unit
For pre-trimming all standard edge types.

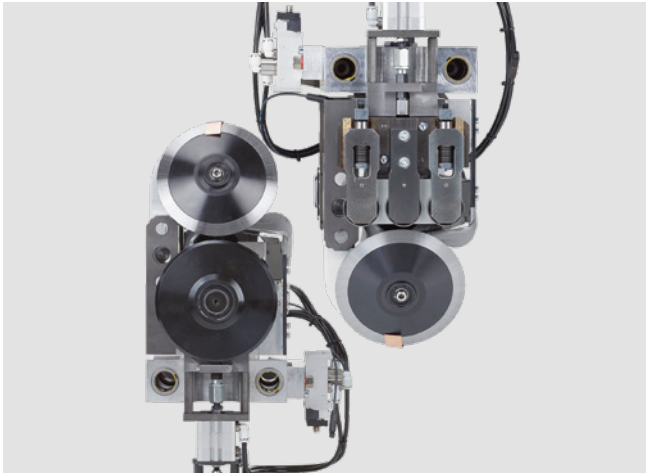

Fine trimming unit
For trimming flat, chamfers and radii with optimized chip extraction and manual adjustment.

Can be automated
Infinitely variable axis adjustment for quick change between e.g. 0.3 mm chamfer to 2 mm radius.

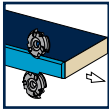
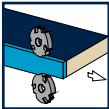

Trimming with multi-level technology

The range of edges and panel materials is continually growing and so is the demand for flexibility. It is immaterial if edges are made from plastic, solid wood or veneer, or if workpieces have high-gloss surfaces. The multi-level trimming unit always offers the optimum profil for frequently changing applications, and therefore the best results.

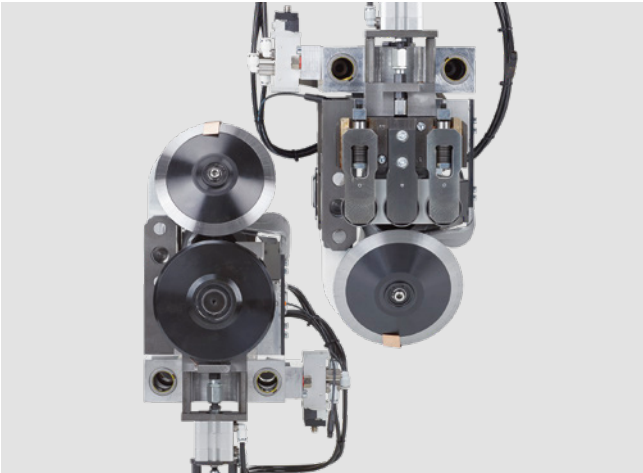

Multi-level trimming unit MS 40
Fully automatic changeover to three different profiles using servo motors*.

* Servo drives consist of motors with infinitely variable adjustment. They impress thanks to a high positioning accuracy and are particularly suitable for small positioning distances.

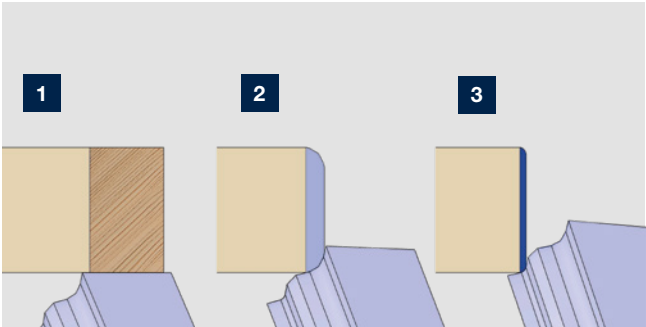

- 1 Flat**
- 2 Profile 1**
- 3 Profile 2**

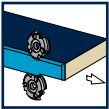

Profile trimming units

The profile trimming units are universal. As a user, you have the option to manually adjust the units or perform programming using the control system. The design is then

executed up to a speed of 20 m/min with extreme precision. Our profile trimming units enable both corner rounding and trimming of the upper and bottom edge overhangs.

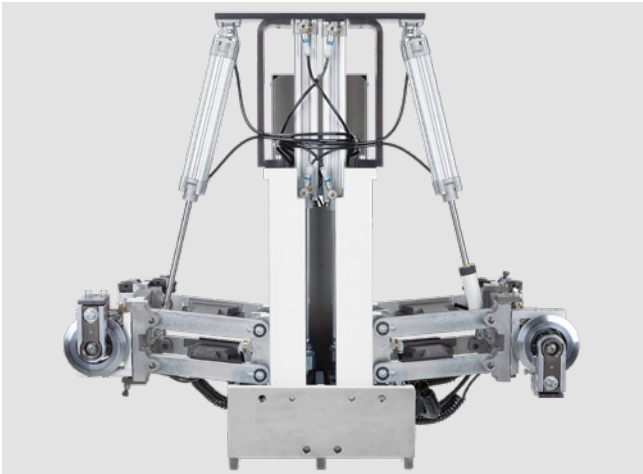

FF20 profile trimming unit

For rounding corners on thick PVC edges, as well as top edges on post-forming and soft-forming parts. Equipped with automatic adjustment between thin and thick edges. Workpiece thickness 60 mm.

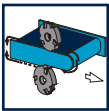

MF50 multifunction trimming unit

For processing edge overhangs on the upper and bottom edge of the workpiece and copying of the corners of the front and rear edge. Equipped with automatic adjustment between thin and thick edges. Workpiece thickness 60 mm.

Automated in standard

Infinitely variable axis adjustment for quick profile changes and adaptation to different edge thicknesses.

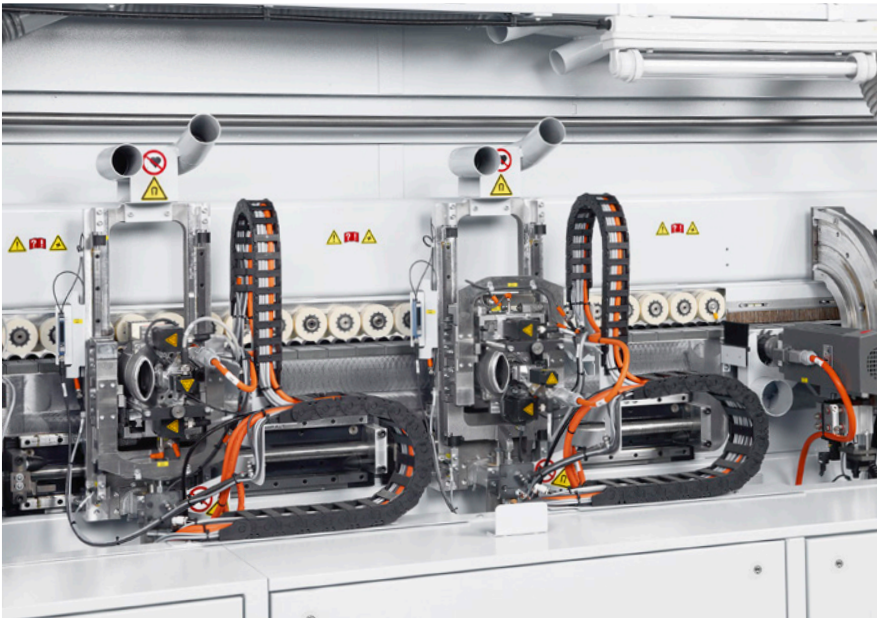
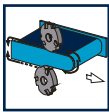

MF60 Servotrim multifunction profile trimming unit

For processing edge overhangs on the upper and bottom edge of the workpiece and for corner rounding of the front and rear edge. Servo-controlled motion sequence with Soft Touch function, for optimum processing of high-gloss surfaces or lightweight panels, for example. Workpiece thickness 60 mm.

Automated in standard

Adjustment to two different radii as well as automatic adjustment of the detector rollers.

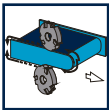

Highlights of the new tool system

- Robust mechanics
- Closed system that can be easily maintained from the outside without being dismantled
- Sensory detection of the tool levels — for clear determination of the tool position
- Safe tool positioning thanks to special adjusting axes

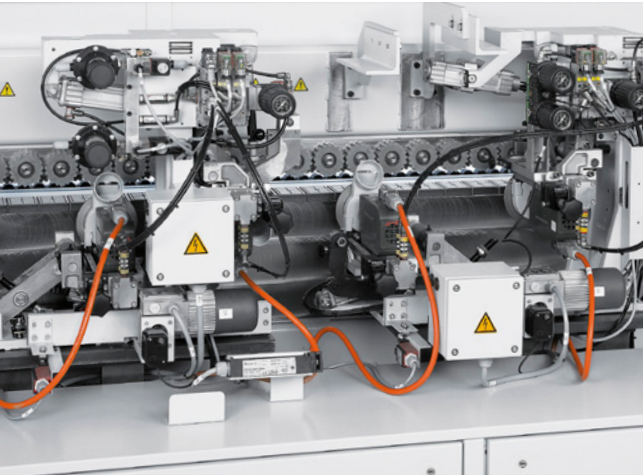

FF12 profile trimming unit

For corner rounding of thick PVC edges as well as top edges on post-forming and soft-forming parts up to a feed speed of 20 m/min. Equipped with automatic adjustment to all edge thicknesses. Workpiece thickness up to 60 mm.

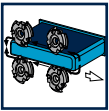

Structural shelves

Profile trimming is also possible on workpiece sides without an edge. This applies not only to structural shelves, but also to upper and lower shelves, shelf inserts and partition panels.



Groove milling unit

A swiveling groove milling unit is available for grooving. If required, the workpiece underside and the front sides can be grooved.

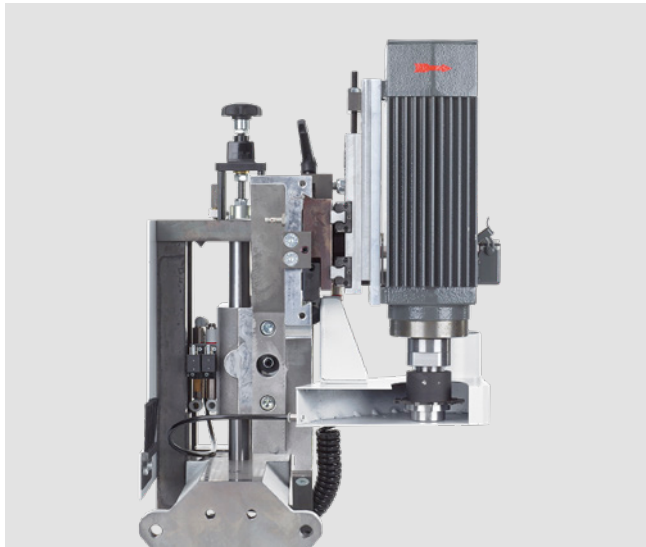

Swiveling groove milling unit

For grooving the workpiece underside and the front sides. For producing continuous, non-continuous and interrupted grooves.



Safety pressure device

For grooving in solid wood strips in synchronous operation. On the 1670 FGC model.

Finishing units

Perfectly coordinated finishing units enhance the quality of your products. With optimally matched finishing units, HOMAG makes the quality of your products perfect.

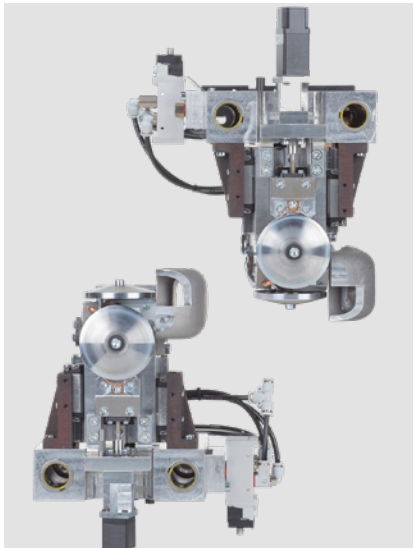

MZ40 multi-level scraper unit

Fully automatic conversion to two different profiles through the use of servo motors with infinitely variable adjustment.

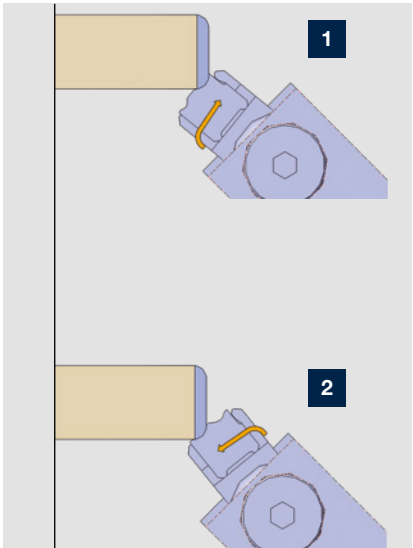

1 Profile 1

2 Profile 2

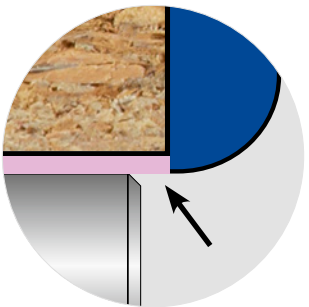

Optimum compensation for protective films

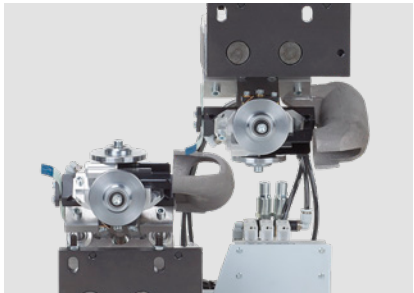

Profile scraper unit

Unit for smoothing radii and chamfers. Equipped with changer heads to allow rapid profile changes.

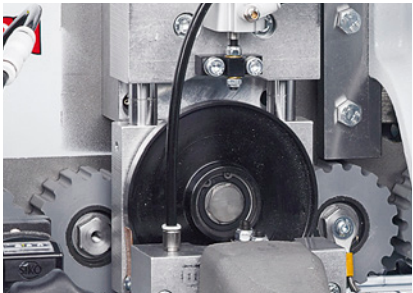
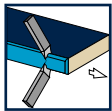

Glue joint scraper unit

For the perfect finish.

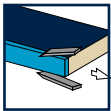

Buffing unit

For polishing edges for a natural color.



Special processing

To extend the range of functions of the machines for individual situations, we offer solutions for processing workpieces with protective film/high gloss, as well as for processing, for

example, sharp-angled or blunt-angled parts or parts with hinge holes, as produced in nesting.

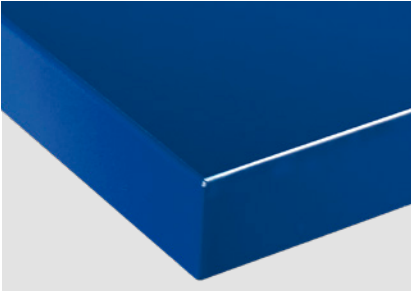

Workpieces with protective film/high gloss

For perfect high-gloss parts, the lubricant spraying device and the motorized top roll pressure unit are used.

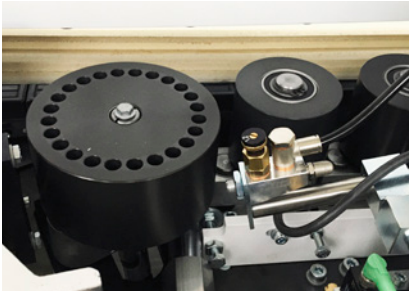

Lubricant spraying device



Motorized top roll pressure unit

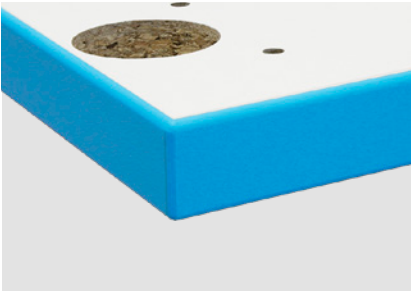

Workpieces with hinge holes (nesting method) or sharp/blunt-angled workpieces

Depending on the unit configuration, different tracing elements are installed. They are ideal for processing parts with hinge holes, such as those produced in nesting, as well as sharp-angled or blunt-angled parts.

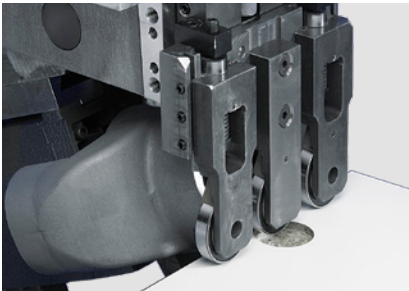

Tracing elements for hinge holes



Small parts processing

Greater flexibility in the production spectrum, as optimum workpiece guidance and processing are also provided for workpiece lengths < 240 mm to a minimum of 120 mm. This is achieved by a narrow roller pitch at the top roll pressure unit.

LOOPTEQ returns: Increased productivity for your edge banding machine

Workpiece returns of the LOOPTEQ series are an optimal supplement to the machines of the EDGETEQ S-380 series. Single-person operation enables you to optimize your workpiece return flow, resulting in a streamlined and efficient

production process. Depending on your requirements, you can combine your machine with a LOOPTEQ O-200 or a LOOPTEQ O-300.

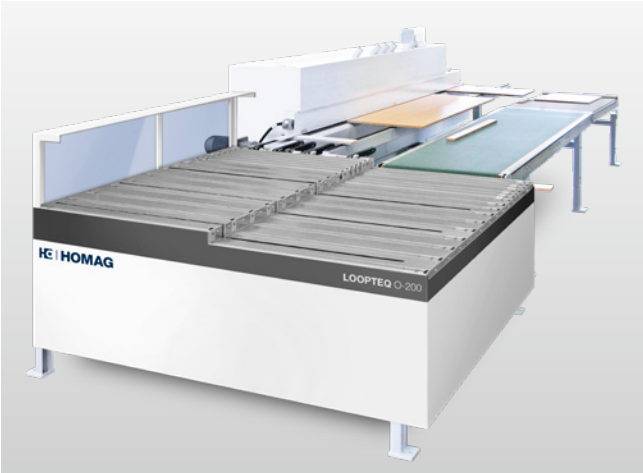

LOOPTEQ O-200 — ideal for small, narrow and medium-sized workpieces

- Fast return on investment — pays for itself from just nine hours of operating time per week
- Flexible personnel organization thanks to cost-effective single-person operation
- Ergonomic working — manual parts handling is reduced to a minimum
- Better quality control — quick response to material adjustments

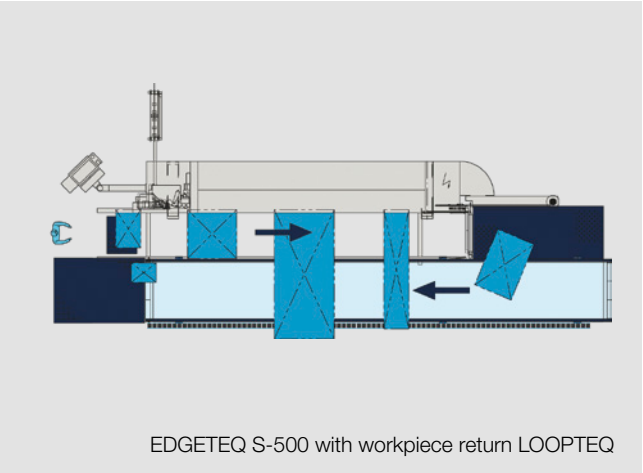

LOOPTEQ O-300 — ideal for a wide range of parts, from small and light workpieces to large and heavy ones

- Fast return on investment — pays for itself from just 15 hours of operating time per week
- Minimal quality costs — gentle workpiece handling with air cushion table
- Flexible personnel organization thanks to cost-effective single-person operation
- Ergonomic operation — staff no longer have to endure heavy physical work

Technical data

| | LOOPTEQ O-200 | LOOPTEQ O-300 TFU 140/20 | LOOPTEQ O-300 TFU 140/25 |
|----------------------------|---------------|-----------------------------|-----------------------------|
| Workpiece length (mm) | 300–2500 | 300–2500 | 240–2700 |
| Workpiece width (mm) | 50–1450 | 60–800 | 60–1000 |
| Workpiece thickness (mm) | 8–60 | 8–60 | 8–60 |
| FOUR-SIDED PROCESSING* | | | |
| Min. workpiece size (mm) | 300 x 300 | 300 x 80 | 240 x 80 |
| Max. workpiece size (mm) | 1450 x 1450 | 2000 x 800 | 2500 x 1000 |
| MISCELLANEOUS | | | |
| Max. workpiece weight (kg) | 50 | 50 | 50 |
| Surface weight (kg/m²) | 25 | 25 | 25 |

*In four-sided processing, larger parts can be returned or ejected with manual assistance in the event of transverse offset or rotation.

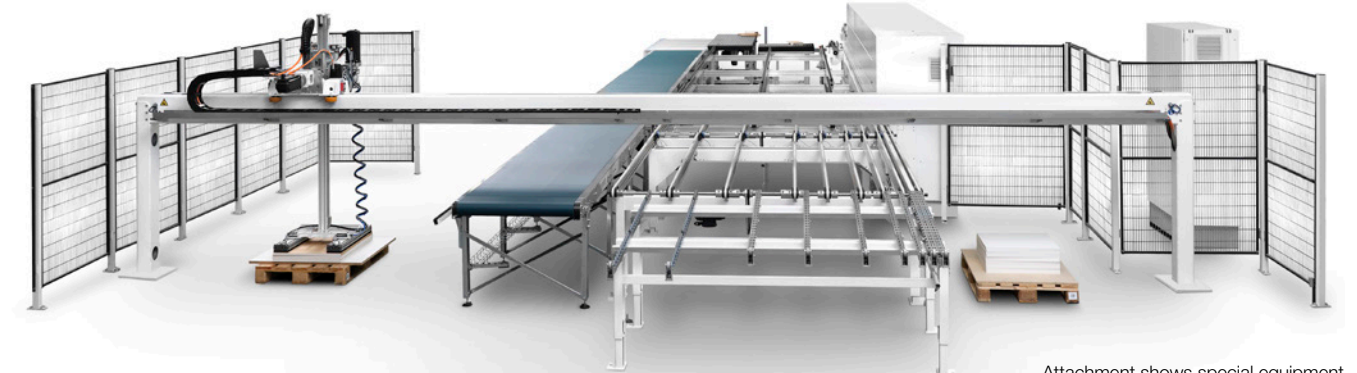

Attachment shows special equipment

Return conveyor system **LOOPTEQ O-400**

Optimize your production with the new LOOPTEQ O-400! By combining a stacking system with a workpiece return, your production process will be taken to a new level. The high automation of the edge banding machine enables quick and easy removal or stacking of finished parts and ensures

smooth workflows. Flexibility and a small footprint make the LOOPTEQ O-400 the perfect addition to your production. It is ideal for small and large manufacturing halls and relieves employees of heavy physical work.

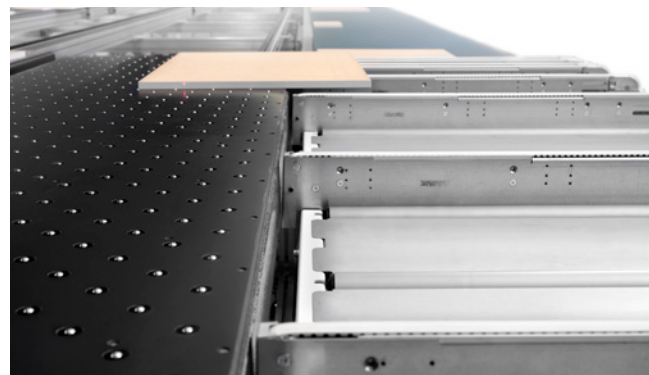

Angular workpiece handover

The angular handover with lifting function returns the workpieces to the operators working height.

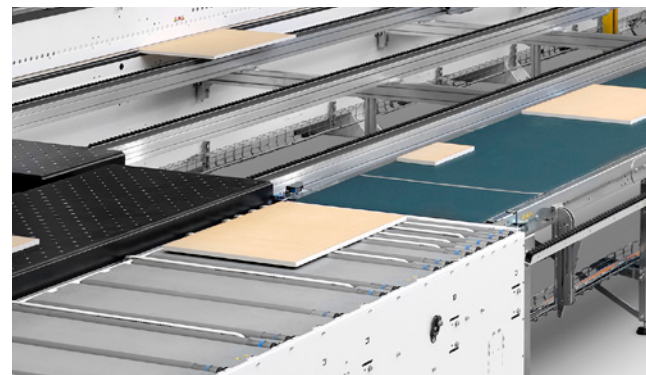

Collecting workpieces

Workpieces can be conveyed as a layer via the angle handover and stacked collectively via the traverse.

Your benefits at a glance:

- **Compact design** reduces the floor space requirement and is ideal for manufacturing spaces with low ceilings
- **Ergonomic** design to relieve your employees
- **All-in-one:** One control panel and integrated machine control ensure easy operation
- **Attractive** price-to-performance ratio
- **In case of service,** only one contact person is necessary

Technical data

| | LOOPTEQ O-400 |
|-----------------------------------|---------------|
| 4-sided processing* | |
| min. workpiece size [mm] | 240 x 120 |
| 4-sided processing* | |
| max. workpiece size [mm] | 3.100 x 1.300 |
| Workpiece thickness [mm] | 8 – 60 |
| workpiece weight max. [kg] | 80 |

**Depending on the equipment of the processing machine; other workpiece dimensions on request.



The EDGETEQ S-380 profiLine offers more

Compared to the preconfigured models of the EDGETEQ S-380 series, the EDGETEQ S-380 profiLine series is freely configurable and offers additional units and even more flexibility.

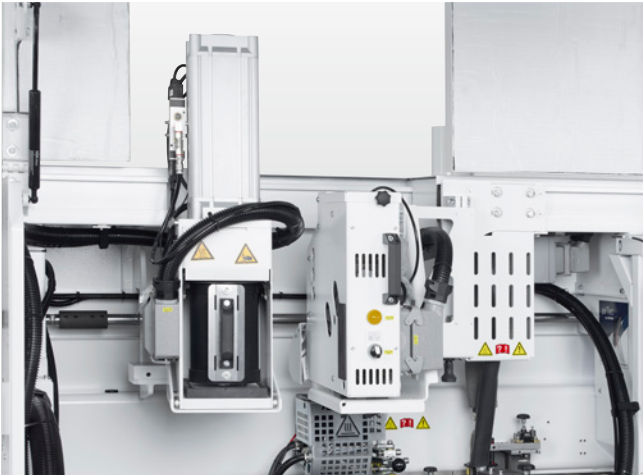

Several edge banding processes on one machine
The EDGETEQ S-380 profiLine offers the option of using several processes on one machine. The figure shows, for example, two melting units for the alternative processing of PUR and EVA. The airTec zero joint technology can also be used on this machine at the same time. This ensures maximum flexibility.



Processing of edges up to 20 mm
For a high degree of flexibility in the edge selection, solid strips of up to 20 mm can be processed.

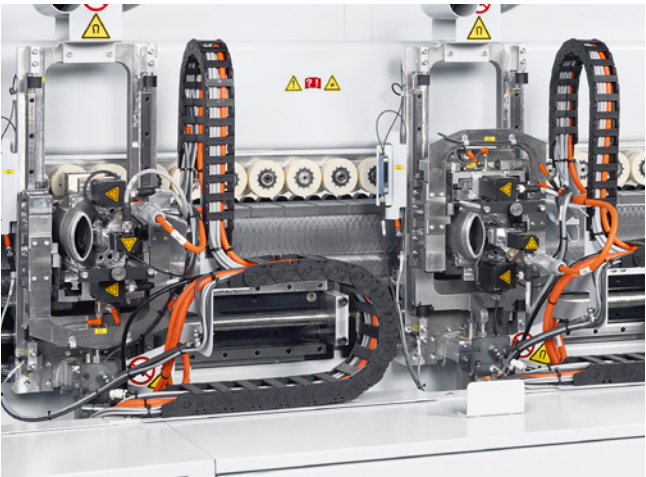

Multiple use of the same units on one machine
For special processing operations, it makes sense to set up a unit several times on one machine. The EDGETEQ S-380 profiLine allows you to do this. On this series, for example, the MF60 multi-function profile trimming unit can be used several times — for a wide range of different radii.

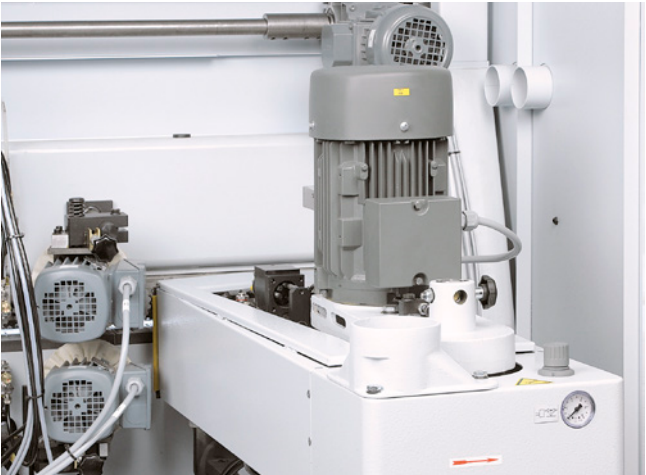

Belt sanding unit
For sanding straight veneer and solid edges, including oscillation in the standard version.



Universal trimming unit for grooving and profiling
Universal unit with high performance for grooving and profiling. Flexible thanks to unlimited configuration options.



Safety pressure device
For grooving in solid wood strips in synchronous operation.

Apps and digital assistants.

Quick and easy support in your machine environment.

Some people still use pen and paper to create their cutting patterns. But they look at their smartphone if they want to know what the weather is like – instead of looking out of the window. We asked ourselves: why not combine the best of both? Our apps and digital solutions make your everyday work easier: machines, material, tools, cutting patterns, components – you always have everything in your pocket or on your desk.

EXCERPTS FROM YOUR FEEDBACK:

- Are there simple solutions that can eliminate various obstacles in my day-to-day work (e.g. when organizing materials or sorting parts)?
- Is there a way to slowly approach using digital assistants?
- Which tools can you try out simply and easily without having to invest huge sums of money straight away?

OUR ANSWER? SMART AND POWERFUL SOLUTIONS:

- ✓ Always low investment
- ✓ Always up to date (no updates necessary)
- ✓ Always easy to use (no complex software)
- ✓ Always helpful

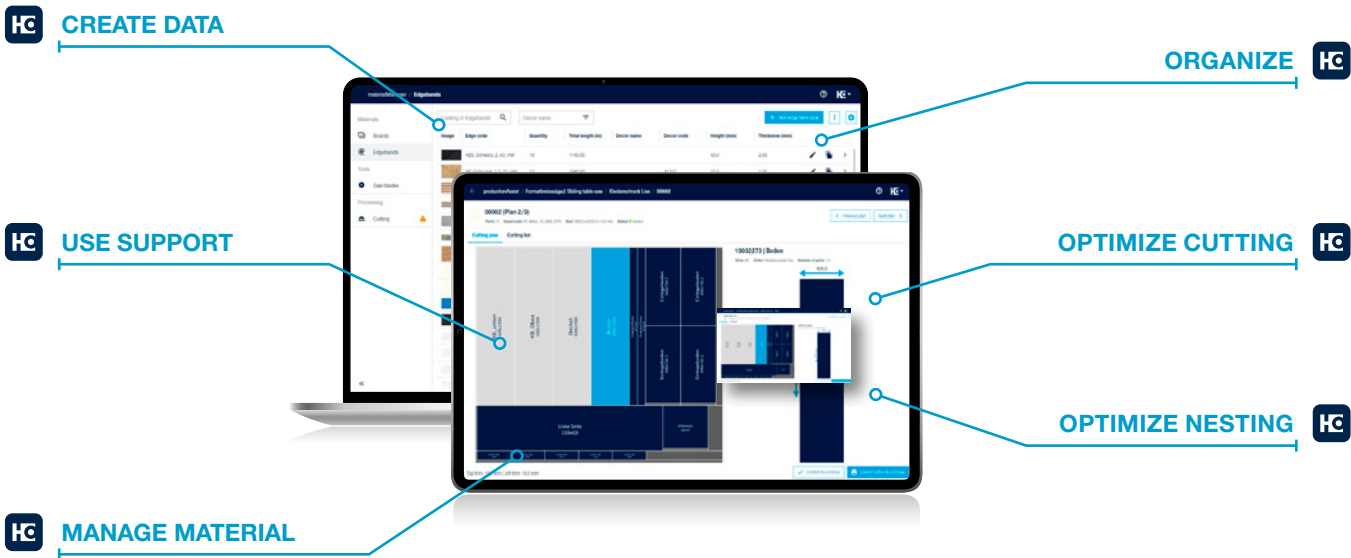

THE ADVANTAGES AT A GLANCE

- No investment, update or maintenance costs
Low starting price, no unplanned financial expense
- Licenses are independent of the user
Any number of employees can use the application without incurring additional costs
- Independent of hardware and operating system
Can be used anywhere, anytime
- Open system – import possible from almost all systems (ERP, industry software, CAD/CAM, Excel, CSV)
No obligation to use specific software systems
- Simple, smart operation
Minimal training required
- More efficient production
Jobs completed more quickly, more safely and in higher quality



More information at
digital.homag.com

woodCommander⁶

Start smart. Finish fast.

Software for quick selection of the processing programs and the edge material. For the reliable and fast acquisition of production parameters as well as the workpiece-oriented creation of machine programs. The new operating platform makes it easier to handle complex machines thanks to consistent digitalization and simplified operation, a reduced number of clicks due to program linking and improved operator guidance.



Fast

- Fewer clicks — e.g. by combining parameters
- Quick program change thanks to preview images from the 3D simulation
- Permanent overview window for quick orientation
- Fast overview thanks to scaled WYSIWYG representation
- Focus on processing steps
- Faster entries thanks to the pop-up keyboard with predicted text
- Situation-specific display of relevant parameters
- Time and cost savings thanks to fewer sample workpieces
- High quality, even for the first workpiece

Safe

- High operating reliability thanks to real 3D workpiece simulation
- Display of the dimensioning directly on the 3D workpiece
- Understanding the processing steps thanks to the simulated effect on the workpiece as well as the switchable tool track
- Automatic check of impermissible parameter combinations with suggested solutions — e.g. if the edge is too thick: "Change edge thickness" or "Switch off scraper"
- Setup with manual adjustments via QR code
- Identification of unsaved program parameters

Flexible

- User-specific arrangement of parameters
- Maximum flexibility thanks to widgets for programs, edge material ...
- Individual integration of edge macros into the program
- Standardized tool management via HOMAG ToolManager
- Demand-based switching of operating parameters, e.g. of the joint dimension
- Integrated user rights management — e.g. only authorized employees may change programs

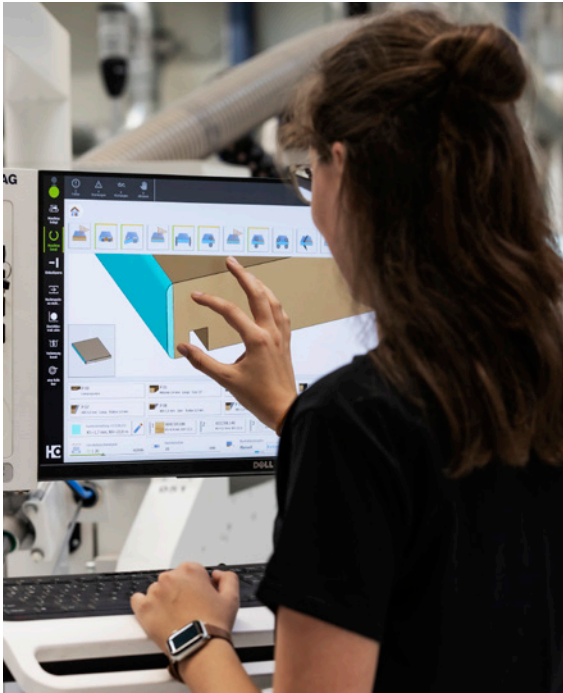

With just a few clicks, you can access the workpiece program.

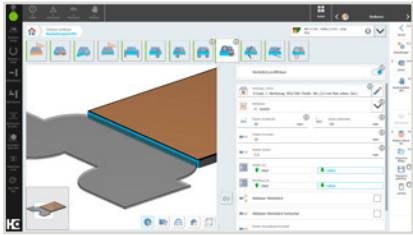

3D workpiece simulation with tool track that can be displayed or hidden.

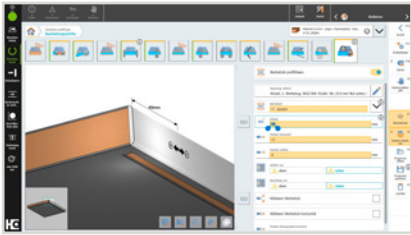

When the parameter is selected, the dimensions are displayed on the workpiece.

NEW: Simplest user interface

With the "simplest user interface," we offer a solution for operators without suitable qualifications so that our highly automated machines can be operated flexibly. In various countries and divisions, operators who do not have the required qualifications are often deployed. With our lowest user level, only the basic processing programs are displayed, while access to other functions is blocked and can only be changed at a higher user level. This means that even inexperienced operators can operate the machine safely and efficiently.



NEW: Allocate edge material

It used to be the case that the edge material for a planned piece of furniture was already processed for another job before the job started. But that is now a thing of the past. With our new function, you can allocate edge material for your projects. As soon as a roll of this material is inserted in the machine, the operator is prompted to define whether they want to process the allocation or whether they want to use the remaining available material. This allows us to ensure that every job is processed with the correct materials—just as you wish.

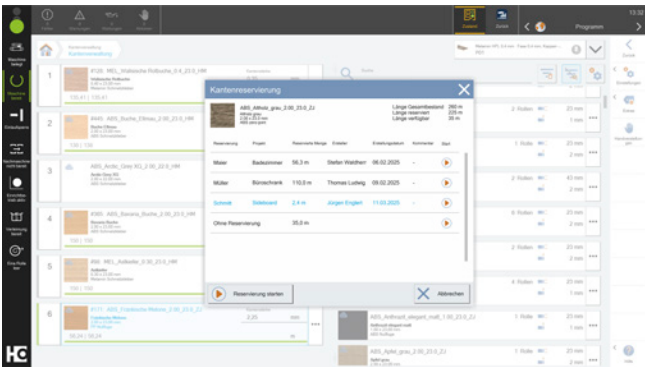

EDGE DATA PACKAGE

Managing your edge data has never been easier! Don't have an overview of your edgeband stock? Did you run out of edgeband material or order too much? The Edge Data Package (Edge Data plugin + Edgeband Management Set) enables you to access a catalog containing all edgeband data from leading edge suppliers directly on the machine. While woodCommander makes direct operation on the machine easier, the plugin links the machine to the Edgeband Management Set.

Your benefits at a glance

- Complete transparency: all information about your edgebands available at a glance.
- Lightning-fast and error-free recording of your edge data – without any manual intermediate steps.
- Easy and continuous access to all edgeband data from leading edge suppliers directly on your machine.
- Sustainable: complete overview of edge stock and storage locations. This reduces duplicated orders and saves costs.
- Efficient networking: With the Edge Data plug-in, woodCommander is used to directly connect your machine (e.g. EDGETEQ S-500) and the edgeband assistant.



Our software solutions

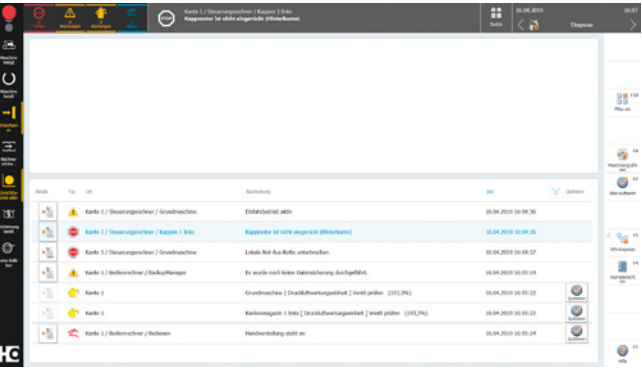

woodScout diagnostic system

In addition to plain text error messages, woodScout displays the location of the malfunction on the machine graphically. In addition to the expert knowledge of the system, you can store your own measures for troubleshooting.

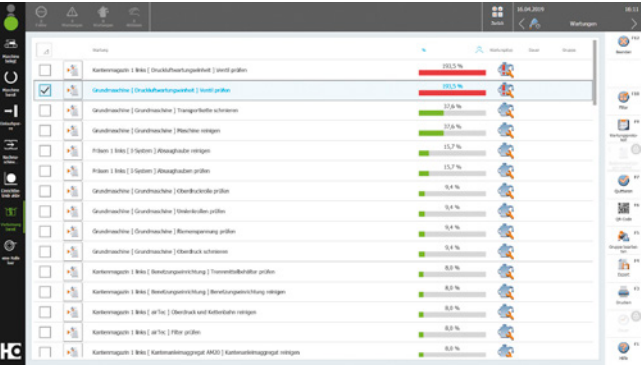

Evaluation with MMR Basic

The software evaluates the productivity of your machine and provides maintenance instructions based on use.



MMR Professional

The extension to MMR Basic also evaluates shifts, analyzes error messages, and allows you to connect to central data evaluation in the office.

The next generation of powerTouch: powerTouch2

Faster, more comfortable, clearer: Enjoy the benefits of our further improved powerTouch user interface. We have optimized our standardized operating concept and further adapted it to our customers' requirements. Controlling your HOMAG machines is now even faster and more intuitive. The new, modern design has a clear structure. The innovative touch operation allows you to achieve the desired result easily and comfortably.

With the new powerTouch generation, you can enter information at your machine even more quickly. Compared to the previous version, you can achieve a time saving of up to 30%. This is possible thanks to new features, such as automatic word completion, a pop-up keyboard that can be kept open and Windows-like functions, such as the selection of common actions directly via the start button.

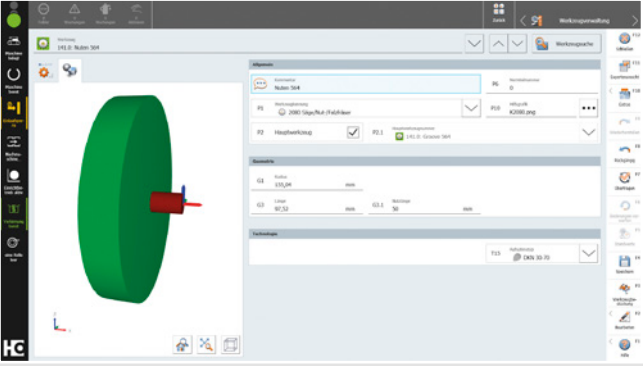

THE HIGHLIGHTS AT A GLANCE:

- Direct and efficient operation, up to 30% faster
- Clearer and more informative thanks to additional information and live illustrations instead of program icons
- New applications for operating and controlling machines and systems (e.g. NCCenter in the PC87 control system on CNC machines or woodCommander 5 on throughfeed machines)
- Fresh, attractive design, based on the new HOMAG machine design

Technical data

EDGETEQ S-380 models

| | Model 1650 FC | Model 1670 FGC | Model 1650 HF | Model 1660 HF |
|-----------------------------------------------------------|------------------|----------------|---------------|---------------|
| Overall length (mm) | 5.773 | 6.273 | 6.773 | 6.273 |
| Adjustable feed (m/min) | 8 – 18 (20 opt.) | | | |
| WORKING DIMENSIONS | | | | |
| Workpiece width (mm) * For workpiece thickness 8–22 mm | 70 | | | |
| Workpiece thickness (mm) | 8 – 60 | | | |
| Edge thickness rollers (mm) | 0,3 – 3 | | | |
| Edge thickness strips/moldings (mm) | 0,4 – 12 | 0,4 – 12 | 0,4 – 15 ** | 0,4 – 15 |
| * Dependent on the workpiece thickness | | | | |
| ** Dependent on the equipment | | | | |

| | Model 1650 E | Model 1660 E | Model 1662 E | Model 1672 E | PROFILINE |
|-----------------------------------------------------------|--------------|--------------|--------------|--------------|---------------|
| Overall length (mm) | 5.773 | 6.573 | 6.575 | 7.075 | 4.773 – 8.273 |
| Adjustable feed (m/min) | 8 – 20 | | | | 8 – 20 |
| WORKING DIMENSIONS | | | | | |
| Workpiece width (mm) * For workpiece thickness 8–22 mm | 70 | | | | 70 |
| Workpiece thickness (mm) | 8 – 60 | | | | 8 – 60 |
| Edge thickness rollers (mm) | 0,3 – 3 | | | | 0,3 – 3 |
| Edge thickness strips/moldings (mm) | 0,4 – 12 | | | | 0,4 – 20 |
| * Dependent on the workpiece thickness | | | | | |
| ** Dependent on the equipment | | | | | |



LIFE CYCLE SERVICES

Improved performance, more efficient processes, faster help, assurance of availability and smarter working

TEAM & COVERAGE

Largest global service network in the industry with over 1,350 personnel.

INSTALLATION & COMMISSIONING

For a smooth start, we only let proven experts manage your setup.

OPERATION & CONTROL

After teaching your personnel the intuitive control system, our clever apps help to make the operator's life much easier.

MAINTENANCE & SERVICING

To keep things running, we're happy to take a preventative approach. You decide how often and how intensively you want the support to be. As we all know, prevention is better than the cure.

eSHOP & ONLINE ADVANTAGE

A few clicks and it's fixed. Receive exclusive advantages by ordering spare parts online, depending on market availability. shop.homag.com

HOTLINE & READINESS

When there's an emergency, we're here. Direct by phone, digitally via app or video, or with on-site support. We are close to you with over 90 regional service organizations worldwide. With more than 35,000 spare parts immediately available, we can deliver 85% of your orders fast.

TRAINING & EDUCATION

With classroom, live online or eLearning training, we offer flexible options to help you get knowledge. We conduct over 4,000 customer training courses every year, and we even have our own training centers in 19 countries

MODERNIZATION & IMPROVEMENT

Our modernization program is tailored to your machines and processes. We can evaluate your data and situation and advise you on the next step.

ANALYSIS & SUSTAINABILITY

On request, we analyze all your processes with proven tools and procedures (LeanSixSigma). We have a large, certified team of experts for this purpose.

FINANCING & CONSULTING

We offer you tailor-made financing concepts worldwide. With more than 60 years of experience and a close partner network of prominent banks and insurance companies to help us to find the right solution for you, we're always transparent and reliable in processing.

Fast support:

94% resolution rate via our hotline

Close to you:

1,350 service experts worldwide

We get things moving:

Over 1,000 worldwide spare parts shipments each day

No one else has that:

Electronic documentation on over 150,000 machines, available in 28 languages



HOMAG Group AG

info@homag.com
www.homag.com

YOUR SOLUTION